



RAZER CORE V2

MASTER GUIDE

The **Razer Core V2** external desktop graphics enclosure enables full transformation of your compatible Thunderbolt™ 3 external graphics enabled laptop into a desktop-class gaming or workstation setup. Attach all your desktop peripherals and never miss a click or keystroke with the world's first dual Thunderbolt 3 internal chip design. The new Razer Core V2 also features an all new internal design with improved headroom for larger graphics cards. Connect to the future with the most advanced and versatile eGPU solution available.

CONTENTS

1. PACKAGE CONTENTS / SYSTEM REQUIREMENTS.....	3
2. REGISTRATION / TECHNICAL SUPPORT.....	4
3. TECHNICAL SPECIFICATIONS.....	5
4. DEVICE LAYOUT.....	6
5. SETTING UP YOUR RAZER CORE V2.....	8
6. INSTALLING YOUR RAZER CORE V2.....	15
7. CONFIGURING YOUR RAZER CORE V2.....	16
8. SAFETY AND MAINTENANCE	19
9. LEGALESE	21

1. PACKAGE CONTENTS / SYSTEM REQUIREMENTS

PACKAGE CONTENTS

- Razer Core V2 external graphics enclosure
- Thunderbolt™ 3 (USB-C™) cable
- Power cord*
- Important Product Information Guide

**may include power cords for specific regions*

SYSTEM REQUIREMENTS

- PC with Thunderbolt 3™ external graphics support
- Razer Core V2 compatible PCI-E graphics card
- Internet connection
- 100MB of free hard disk space

Note: Visit rzd.to/core for compatibility information; and to download the latest driver and firmware updates.

2. REGISTRATION / TECHNICAL SUPPORT

REGISTRATION

Sign up now for a Razer Synapse account to get real-time information on your product's warranty status. To learn more about Synapse and all its features, visit razerzone.com/synapse.

If you are already a Razer Synapse user, register your product by clicking on your email address at the Razer Synapse application and select Warranty Status from the dropdown list.

To register your product online, visit razerzone.com/registration. Please note that you will not be able to view your warranty status if you register via the website.

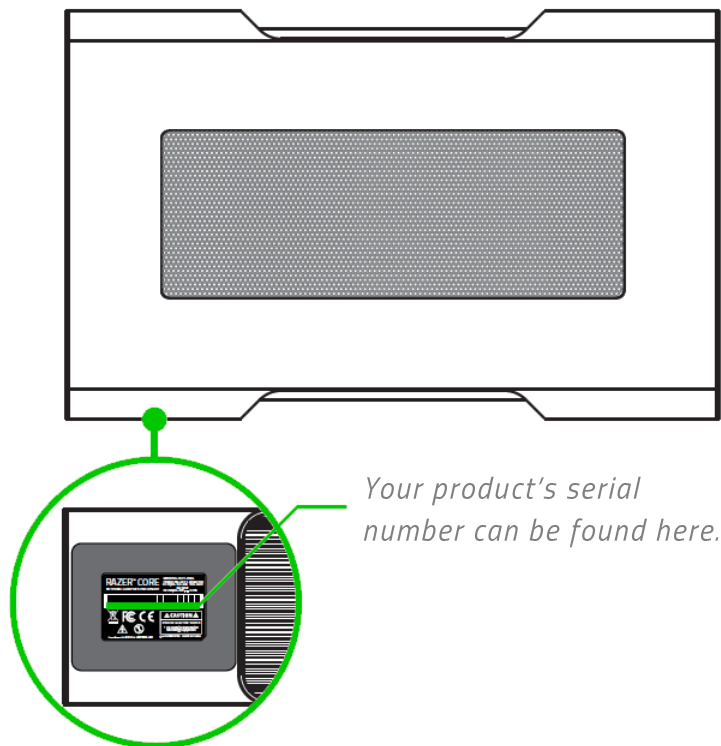

Your product's serial number can be found here.

TECHNICAL SUPPORT

What you'll get:

- 1 year limited manufacturer's warranty.
- Free online technical support at razersupport.com.

3. TECHNICAL SPECIFICATIONS

TECHNICAL SPECIFICATIONS

- Model No.: RC21-0116
- Product No.: RC21-01160100
- Connection to PC: Thunderbolt™ 3/USB-C™ (up to 40Gbps) cable
- GPU Support (Desktop graphics card not included)
 - GPU Type: Single double-wide, full-length, PCI-Express x 16 graphics card
- Razer Core V2 Inner Dimensions (Approx.): 11.81 in / 300 mm (Length*) x 5.12 in / 130 mm (Height) x 1.69 in / 43 mm (Width)
**Height measured from the top of the PCIe connector to the bottom of the locking pin ramps*
- GPU Max. Power Support: 375 Watts
- Graphics Output: Based on the capabilities of the installed graphics card
- Input & Output:
 - USB 3.0 port x4 (Super Speed)
 - Gigabit Ethernet 10/100/1000 Mbps
 - Thunderbolt™ 3/USB-C™ (for connection to PC)
 - A/C Power port
- Chassis Lighting: Powered by Razer Chroma™ – 2 Zones
- Internal Power Supply: 500 Watts
 - AC Input: 100-240V, 6.0A
 - DC output: 20Vdc, 3.25A
 - 6+2-pin output: 150 watts

APPROXIMATE SIZE & WEIGHT

- Length: 353 mm / 13.90 in
- Width: 105 mm / 4.10 in
- Height: 220 mm / 8.7 in
- Weight: 4.94 kg / 10.89 lbs

4. DEVICE LAYOUT

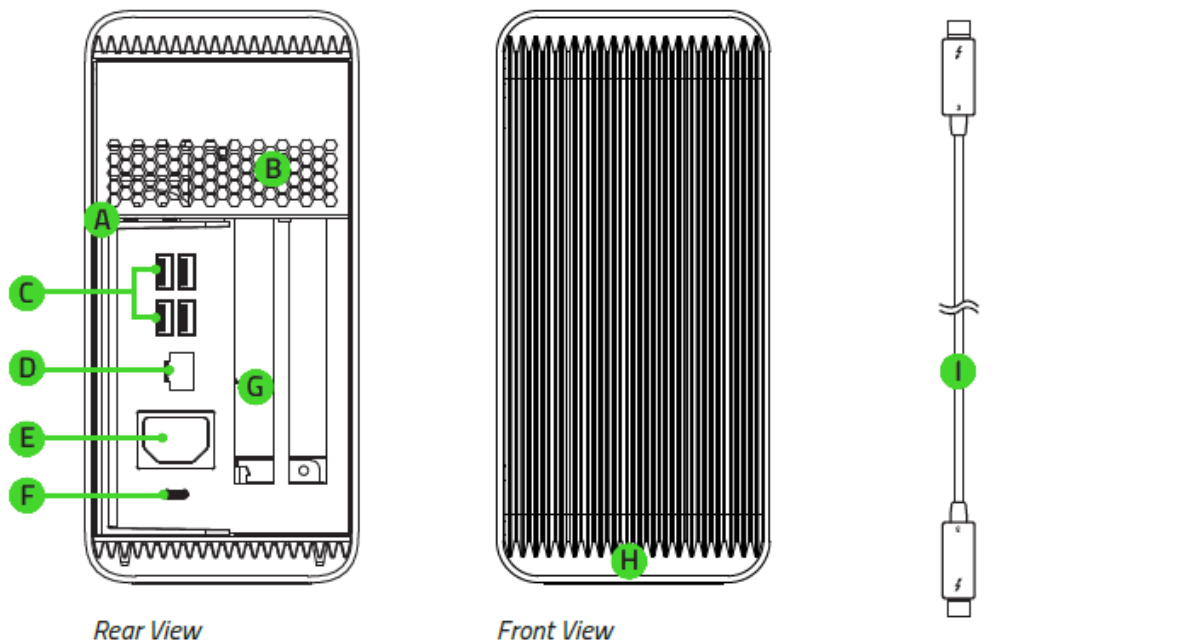

- A. Release lever
- B. Exhaust port
- C. USB 3.0 ports
- D. Gigabit Ethernet port
- E. Power port
- F. Thunderbolt 3 (USB-C) port
- G. PCI-E slot cover
- H. Razer Chroma front lighting
- I. Thunderbolt 3 (USB-C) cable

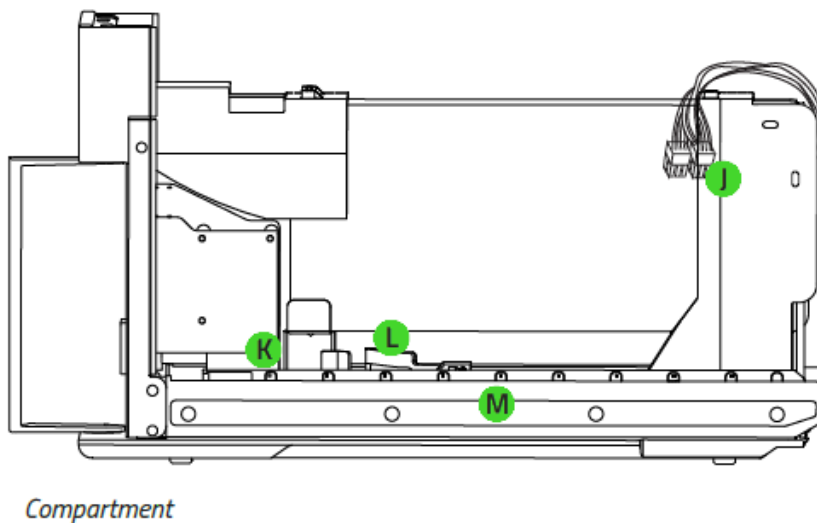

- J. 6+2-pin power connectors
- K. PCI-E port
- L. Release lever
- M. Razer Chroma internal lighting

RAZER CORE V2 MAX INNER DIMENSIONS:

Length: 11.81 in / 300 mm

Height*: 5.71 in / 145 mm

Width: 1.69 in / 43 mm

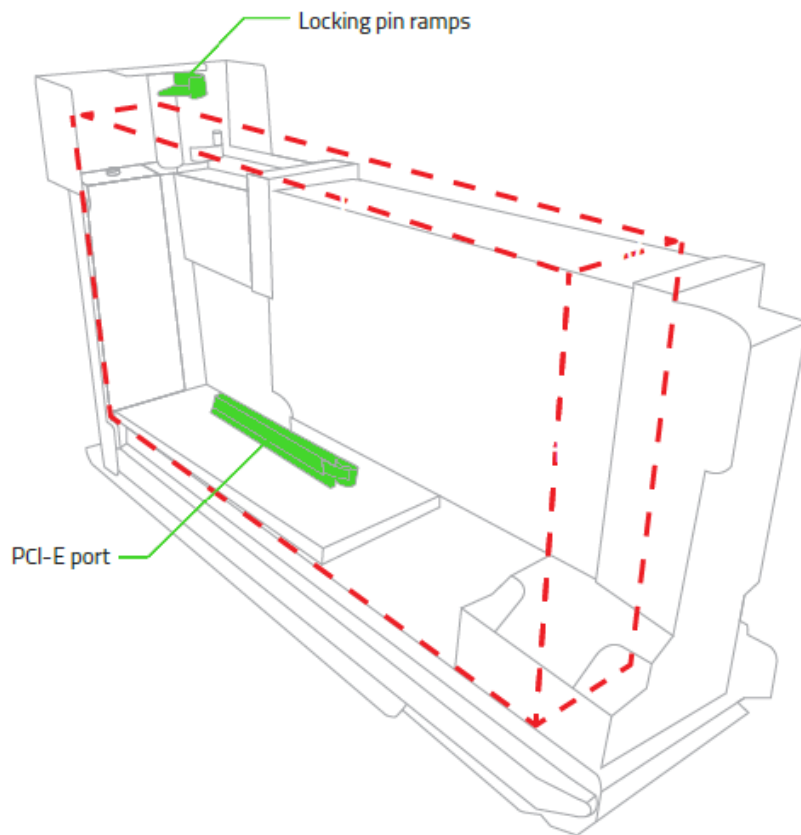

**Height is measured from the bottom of the locking pin ramps to the top of the PCI-E port.*

Ensure that there is enough space for the 6+2-pin power connectors

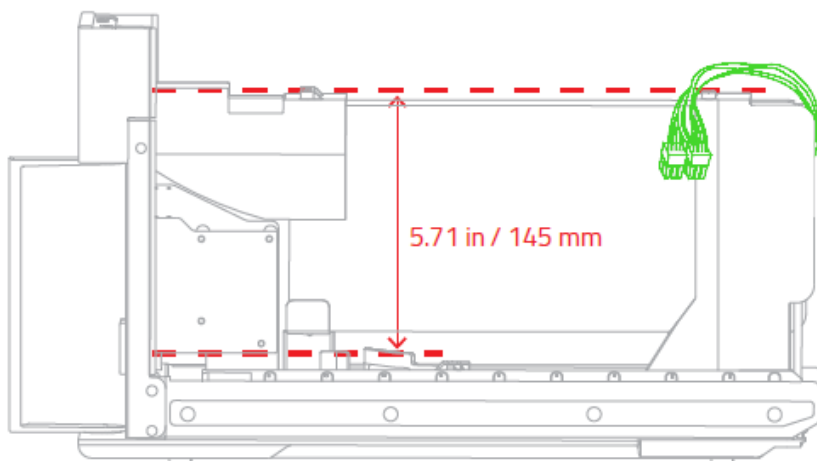

5. SETTING UP YOUR RAZER CORE V2

1. Gently pull the lever to unlock.

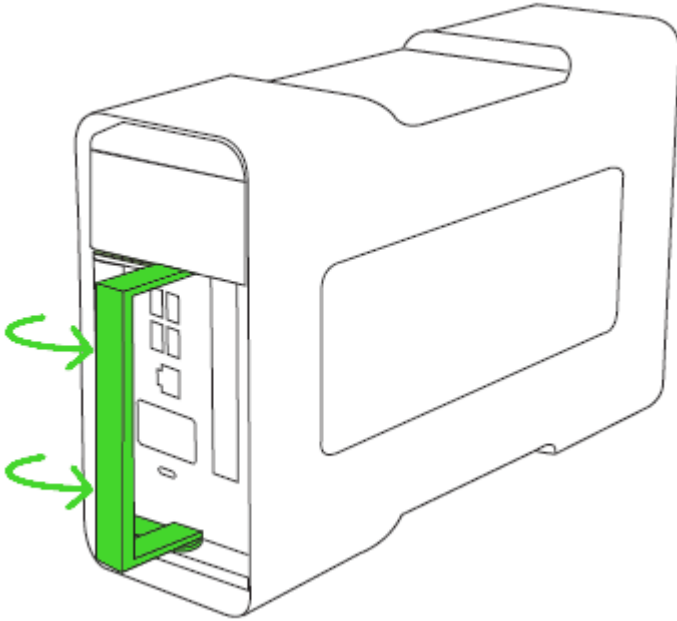

2. Pull out the compartment from the enclosure.

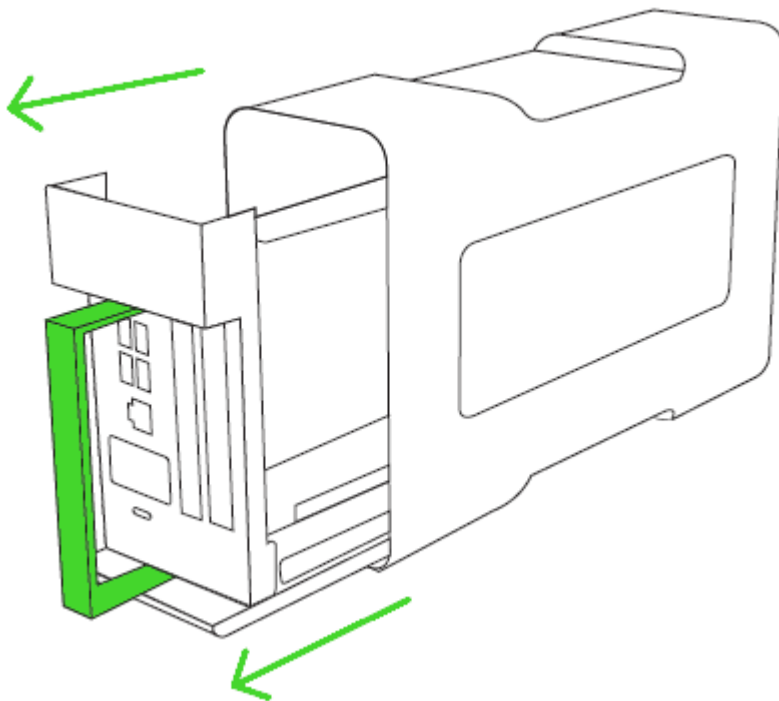

3. Peel off the tape and remove the protective foam.

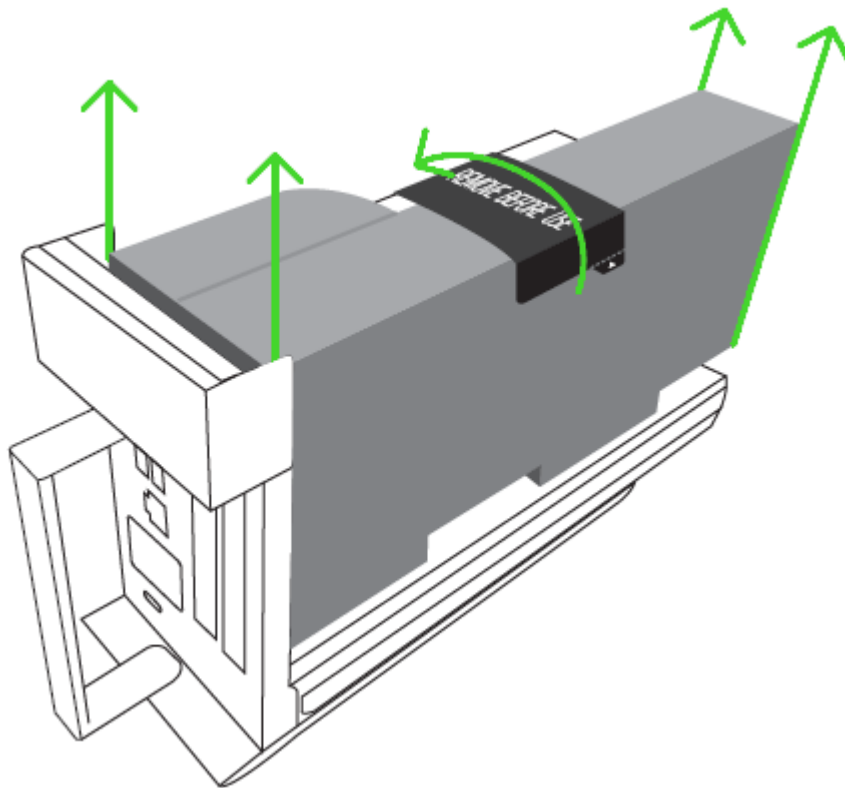

4. Remove the PCI-E slot cover and thumbscrew.

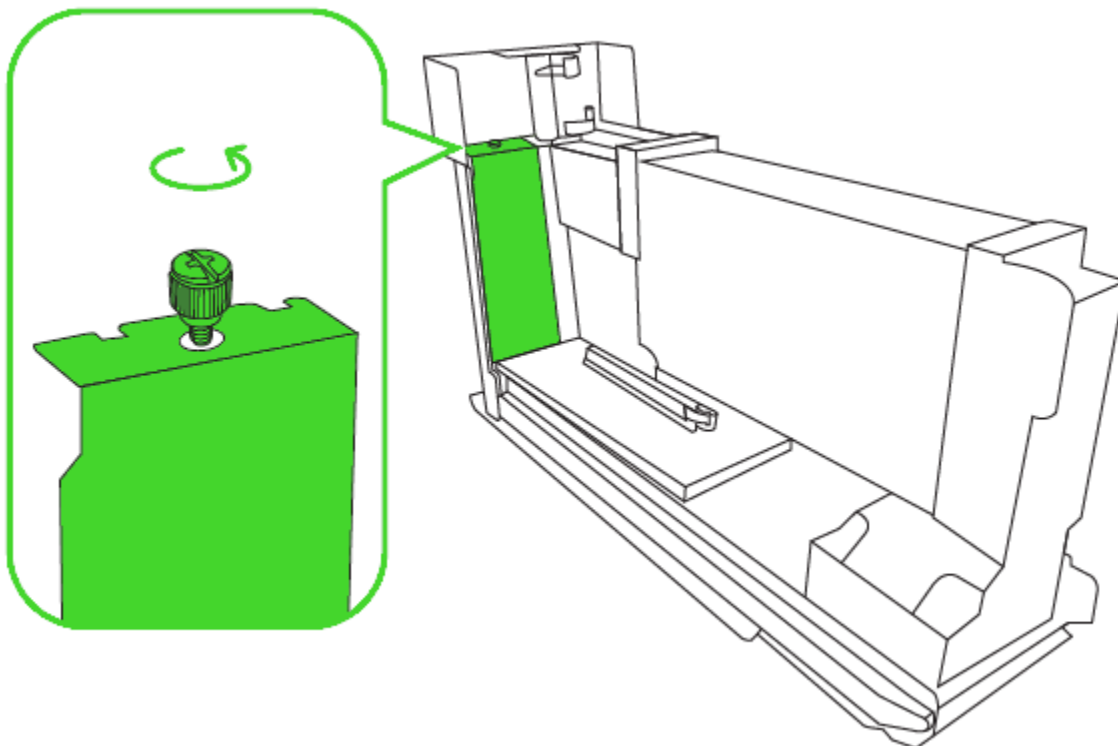

5. Insert your compatible graphics card* to the PCI-E port.

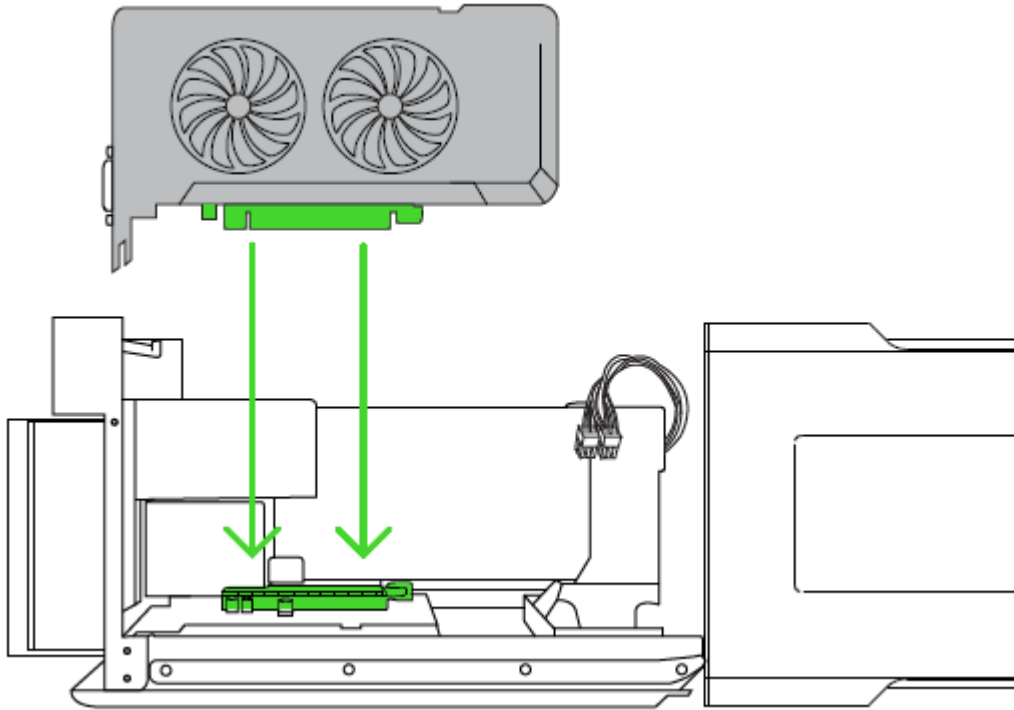

**Not included*

- i** Push the release lever from the opposite side to eject the graphics card. Always push the release lever first before pulling out your graphics card.

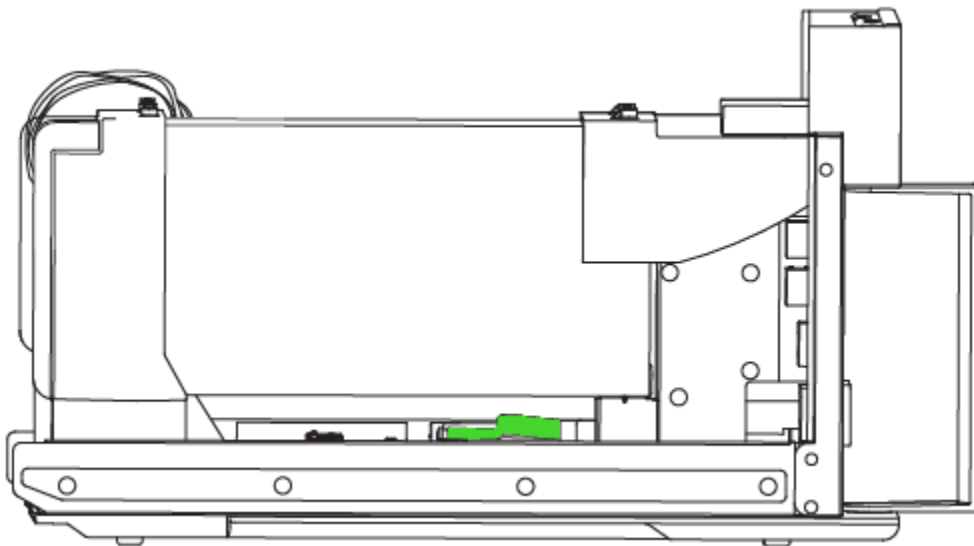

6. Re-insert the PCI-E thumbscrew.

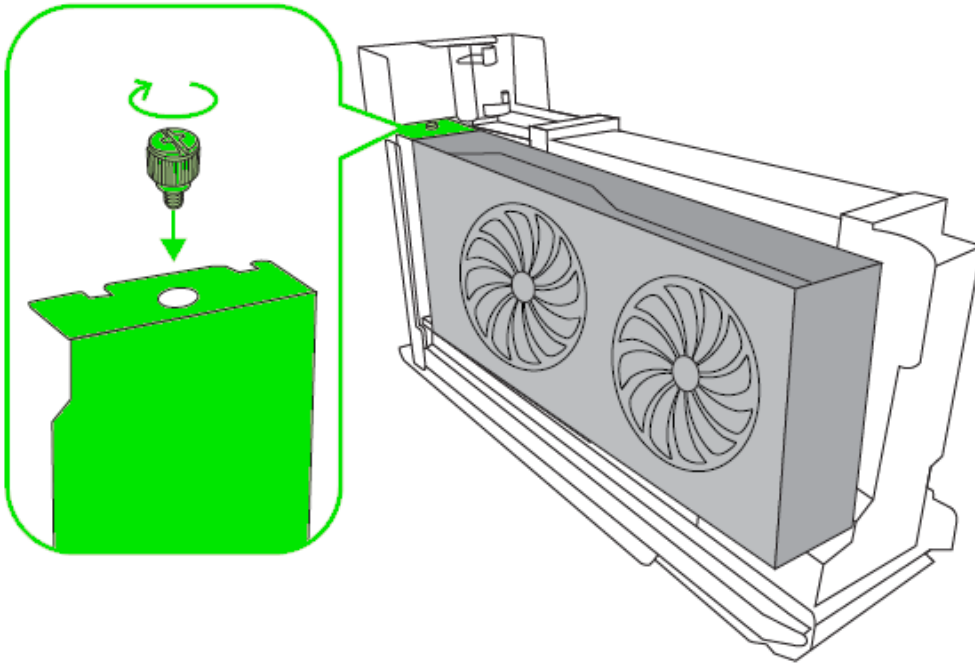

7. Plug the 6+2-pin power connectors to your graphics card.

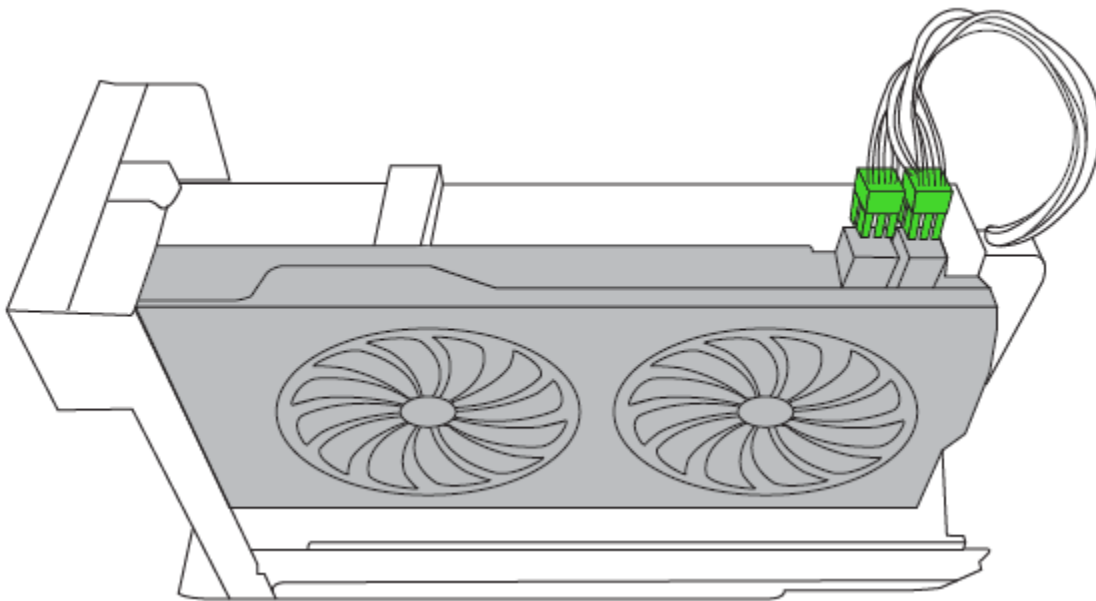

8. Push the compartment into the enclosure until completely shut.

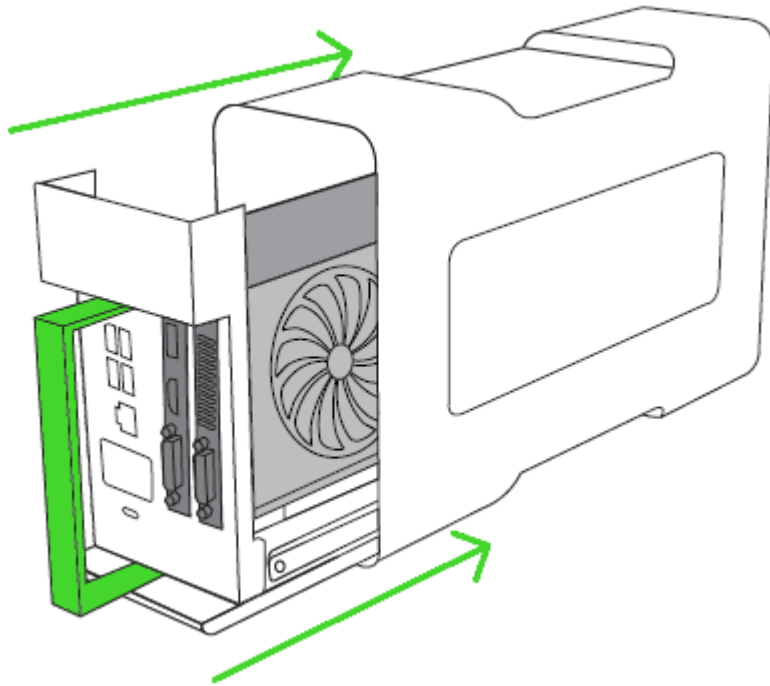

9. Push the lever to lock the compartment.

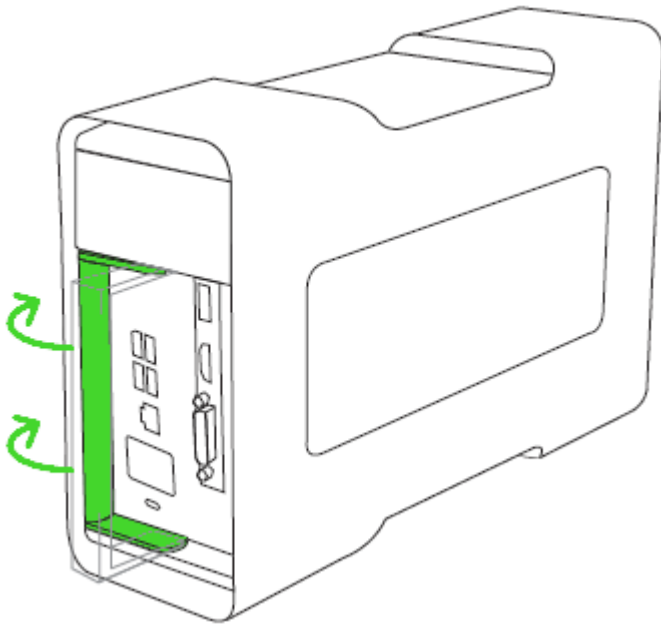

10. Connect the Razer Core V2 to an outlet using the power cord.

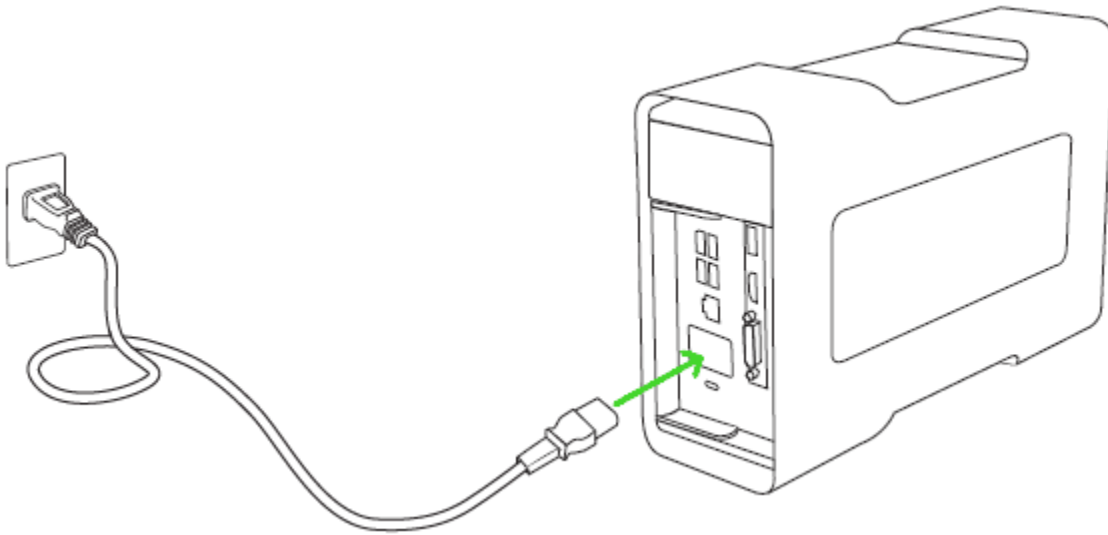

11. Connect the Razer Core V2 to your Razer Blade Stealth using the Thunderbolt 3 (USB-C) cable.

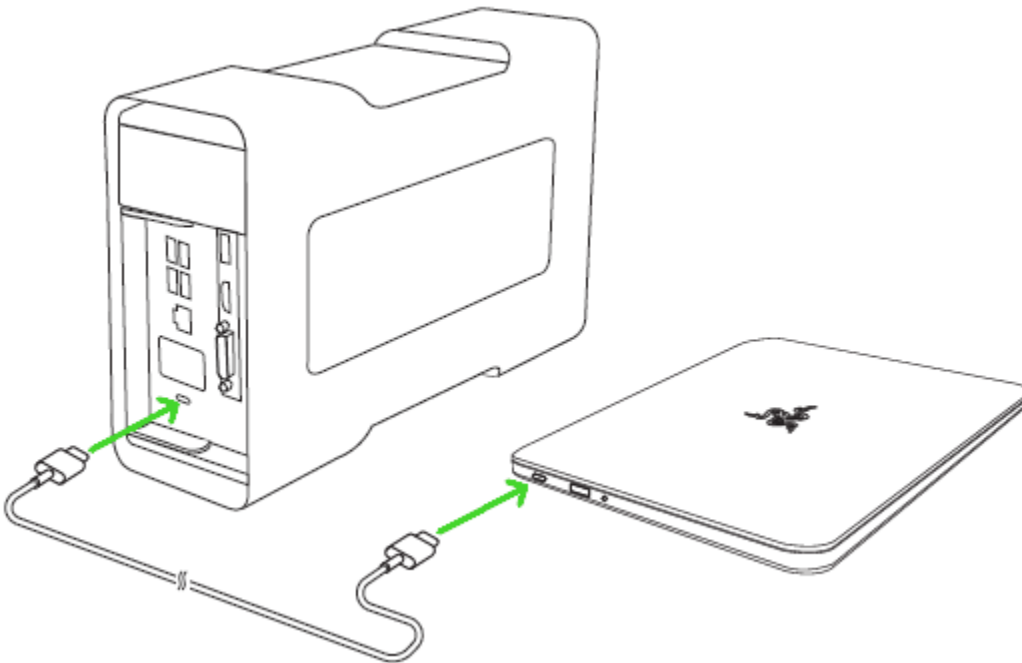

Connecting the Razer Blade Stealth will automatically turn on your Razer Core V2. This connection will also provide power and charge your Razer Blade Stealth.

12. Connect the Razer Core V2 to your external monitor using the display port of your installed graphics card

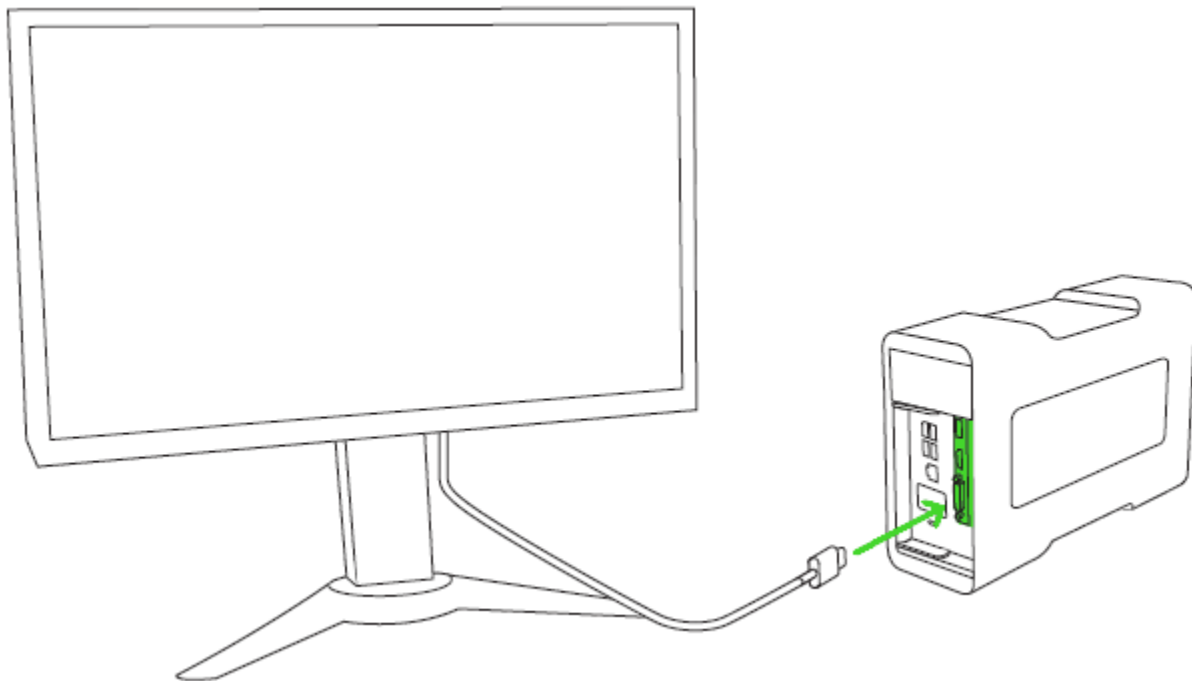

6. INSTALLING YOUR RAZER CORE V2

A SYSTEM UPDATE MAY BE REQUIRED

Your compatible Razer Blade Stealth or Razer Blade may require a software update for Razer Core V2 to function properly. Please check the following website to ensure your system has the latest software installed: rzt.to/core-update

Step 1: Connect your Razer device to the USB port of your computer.

Step 2: Install Razer Synapse Pro when prompted* or download either the Razer Synapse Pro or Razer Synapse installer from razerzone.com/software.

Step 3: Create your Razer ID or log into the Razer software with an existing account.

**Applicable for Windows 8 or later.*

7. CONFIGURING YOUR RAZER CORE V2

Disclaimer: The features listed here require you to log in to Razer Synapse. These features are also subject to change based on the current software version and your Operating System.

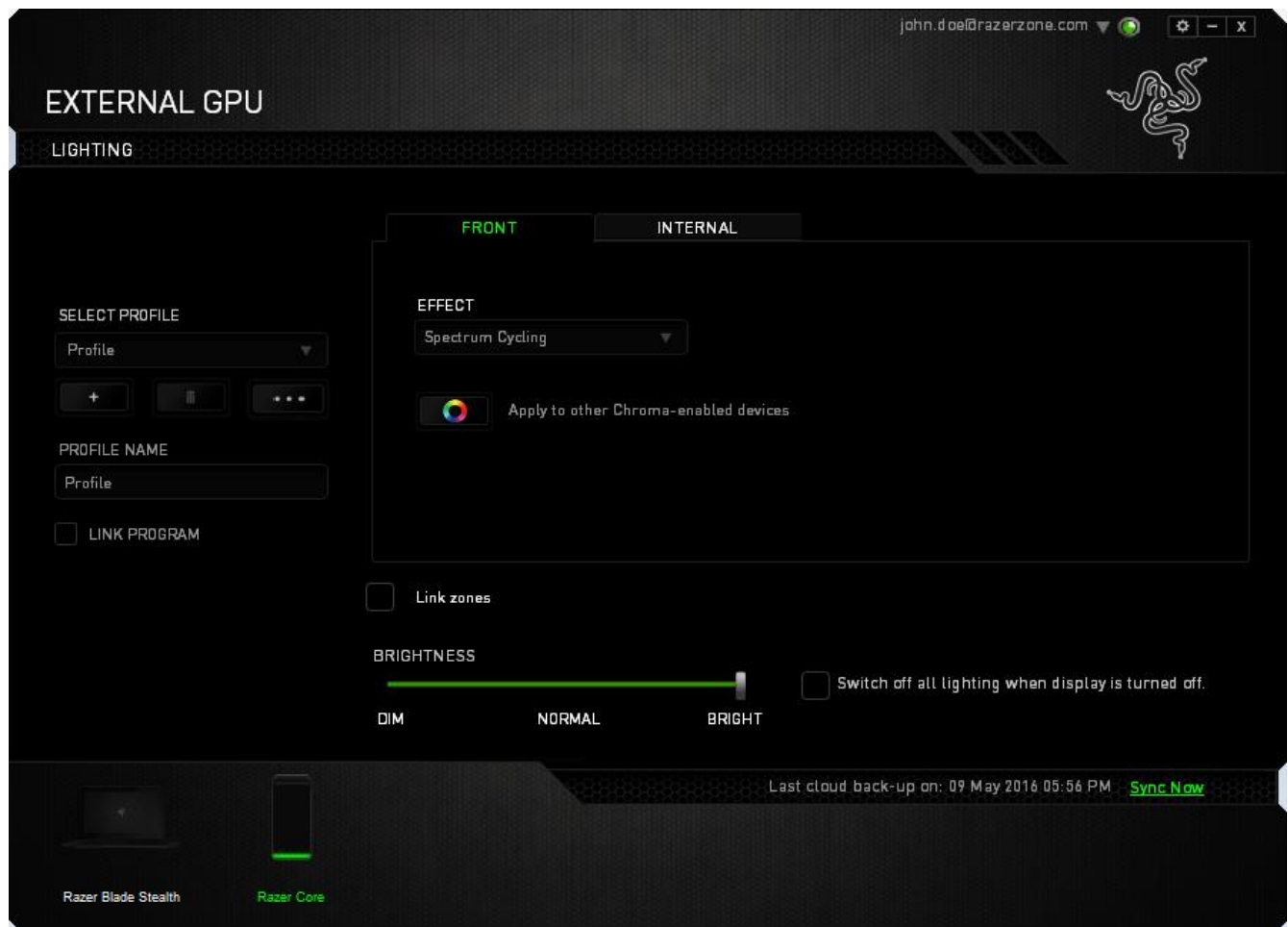

The Razer Synapse configurator allows you to customize your device's LED settings. You can select a pre-loaded lighting effect for the front zone and internal zone or use a single effect for both zones by selecting *Link zones*. Additionally, you can adjust the brightness of the lighting and set to turn off all lighting on the device when your monitor is turned off. Any changes made here is automatically saved to your PC and stored into the cloud servers.

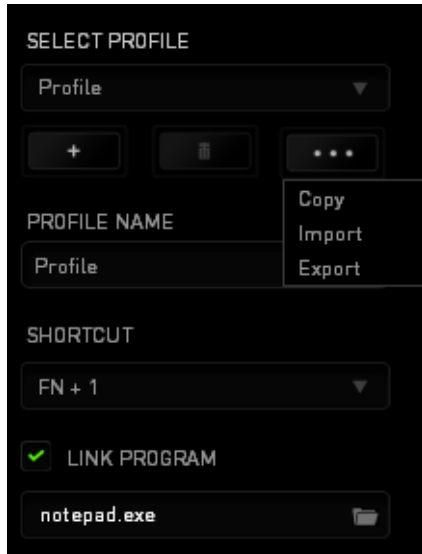

Profile

A profile is a convenient way of organizing all your custom settings and you can have an infinite number of profiles at your disposal. Any changes made within each tab are automatically saved to the current profile and stored into the cloud servers.







You can create a new profile by clicking the  button or delete the current profile by clicking the  button. The  button allows you to Copy, Import, and Export profiles. Your current profile by default is named "Profile" however; you can rename it by typing on the text field below PROFILE NAME. Each profile can also be set to automatically activate when you run a program or application through the use of the LINK PROGRAM option.

Lighting Tab

The Lighting Tab allows you to customize the look of your Razer Core V2 by being able to choose from 16.8 million colors. If you have other Chroma enabled devices, you can synchronize all lighting schemes by clicking the  button.

The synchronization function will only apply to devices that support the selected scheme.

Basic Lighting Effects

	Name	Description	How to set up
	Spectrum cycling	The LEDs will cycle between 16.8 million colors indefinitely	No further customization is required
	Wave	The lighting will scroll in the direction selected with a default spectrum of colors	Default effect. Select either front-to-back or back-to-front wave direction
	Static	The LEDs will remain lit in the selected color	Select the desired lighting color
	Breathing	The lighting fades in and out of the selected color(s)	Select up to 2 colors for this setting

8. SAFETY AND MAINTENANCE

IMPORTANT SAFETY INSTRUCTIONS

WARNING: Failure to follow these safety instructions could result in fire, electric shock, or other injury or damage.

To operate the computer safely and reduce the possibility of heat-related injuries, follow these guidelines:

- Should you have trouble operating the device properly and troubleshooting does not work, unplug the device and contact the Razer hotline or go to razersupport.com for support.
- Do not attempt to service or fix the device yourself at any time.
- Operate the device only within the specific temperature range of 0°C (32°F) to 40°C (104°F). Should the temperature exceed this range, unplug and switch off the device in order to let the temperature stabilize to an optimal level.
- Ensure that the Razer Core V2 is on a stable work surface and does not hinder air circulation from around the computer.
- Do not use or install near water or moisture. Do not use around swimming pools, bath tubs, or other wet surfaces.
- Do not use or install near any heat or naked flame sources. Do not use around radiators, stoves, fire places, candles or other hot surfaces.
- Power sources & voltage warning. This apparatus should only be operated from the type of power source indicated on the apparatus. If you are unsure of the power source in the location you intend to operate the apparatus, please consult the local power company or a qualified technician.
- Do not block ventilation grills or openings. Install in accordance with manufacturer's instructions.
- Unplug the apparatus before cleaning and do not use aerosol or liquid cleaning agents.
- Never place anything over the power adapter when operating your apparatus. Do not place the apparatus on any unstable cart, stand, tripod or table. The apparatus may fall, causing injury to person and damage to property, including the product itself.
- Unplug this apparatus during lightning storms or when unused for extended periods of time to further protect the apparatus.
- Protect the power cord from being walked on or pinched, particularly at plugs, convenience receptacles, or the point where they exit from the apparatus.
- Do not insert or push any objects into openings on the product.

- Do not overload wall electricity outlets, extension cords and plugs. This may result in fire or electrical shock.
- Refer all servicing to qualified service personnel. Servicing is required when the apparatus has been damaged in any way, such as power-supply cord or plug is damaged, liquid has been spilled or objects have fallen into the apparatus, the apparatus has been exposed to rain or moisture, does not operate normally, or has been dropped. Do not attempt to service this apparatus yourself. Removing the covers will expose you to dangerous electric currents.
- Do not take apart the device (doing so will void your 30-days warranty) and do not attempt to operate it under abnormal current loads.
- Do not expose the device to liquids. Exposing the product to these conditions may result in an electric shock.
- Do not expose the device to open flames such as stoves, candles, or fireplaces.
- Dispose the product in accordance with your local environmental laws and guidelines.
- Do not use the product if any cable is damaged or any wires are exposed. Doing so may result in an electric shock.
- Use only the power cord provided with the product to avoid short-circuiting the system.
- Do not tamper or abuse the product; including but not limited to dropping, shaking, crushing, excessive bending, puncturing, shredding, or inserting foreign objects into the device.
- Do not expose the device to fine solid objects such as dust, dirt, and sand.
- Avoid placing the product near devices that emit radio waves such as mobile phones, radio transmitters and Wi-Fi routers as it can be affected by their magnetic interference.

9. LEGALESE

COPYRIGHT AND INTELLECTUAL PROPERTY INFORMATION

©2017 Razer Inc. All rights reserved. Razer, the triple-headed snake logo, Razer logo, “For Gamers. By Gamers.”, and “Powered by Razer Chroma” logo are trademarks or registered trademarks of Razer Inc. and/or affiliated companies in the United States or other countries. All other trademarks and trade names are the property of their respective owners and other company and product names mentioned herein may be trademarks of their respective companies.

Windows and the Windows logo are trademarks of the Microsoft group of companies.

Thunderbolt and the Thunderbolt logo are trademarks of Intel Corporation in the U.S. and/or other countries.

Razer Inc. (“Razer”) may have copyright, trademarks, trade secrets, patents, patent applications, or other intellectual property rights (whether registered or unregistered) concerning the product in this guide. Furnishing of this guide does not give you a license to any such copyright, trademark, patent or other intellectual property right. The Razer Core V2 (the “Product”) may differ from pictures whether on packaging or otherwise. Razer assumes no responsibility for such differences or for any errors that may appear. Information contained herein is subject to change without notice.

LIMITED PRODUCT WARRANTY

For the latest and current terms of the Limited Product Warranty, please visit razerzone.com/warranty.

LIMITATION OF LIABILITY

Razer shall in no event be liable for any lost profits, loss of information or data, special, incidental, indirect, punitive or consequential or incidental damages, arising in any way out of distribution of, sale of, resale of, use of, or inability to use the Product. In no event shall Razer’s liability exceed the retail purchase price of the Product.

COSTS OF PROCUREMENT

For the avoidance of doubt, in no event will Razer be liable for any costs of procurement unless it has been advised of the possibility of such damages, and in no case shall Razer be liable for any costs of procurement liability exceeding the retail purchase price of the Product.

GENERAL

These terms shall be governed by and construed under the laws of the jurisdiction in which the Product was purchased. If any term herein is held to be invalid or unenforceable, then such term (in so far as it is invalid or unenforceable) shall be given no effect and deemed to be excluded without invalidating any of the remaining terms. Razer reserves the right to amend any term at any time without notice.