

RAZER NABU



DOWNLOAD
THE APP



CONNECT
YOUR BAND



LIVE
SMARTER

TABLE OF CONTENTS

1. PACKAGE CONTENTS / SYSTEM REQUIREMENTS	3
2. REGISTRATION / TECHNICAL SUPPORT	4
3. USING YOUR RAZER NABU	5
4. CONFIGURING YOUR NABU VIA THE UTILITY APP	10
5. SAFETY AND MAINTENANCE	20
6. LEGALESE	22

1. PACKAGE CONTENTS / SYSTEM REQUIREMENTS

PACKAGE CONTENTS

- Razer Nabu
- Important product information guide
- Charging cable
- 2 Interchangeable clasps

SYSTEM REQUIREMENTS

- iPhone 5 / 5S / 5C / 6 / 6 Plus with iOS 7 (or higher)
- Android 4.3 (or higher) device with Bluetooth Low Energy (BT 4.0 or higher) capability

2. REGISTRATION / TECHNICAL SUPPORT

REGISTRATION

Sign up now for a Razer ID account to get real-time information on your product's warranty status. To learn more about Razer ID and all its features, visit www.razerzone.com/razer-id. If you are already a Synapse user, register your product by clicking on your email address at the Synapse application and select *Warranty Status* from the dropdown list.

To register your product online, visit www.razerzone.com/registration. Please note that you will not be able to view your warranty status if you register via the website.

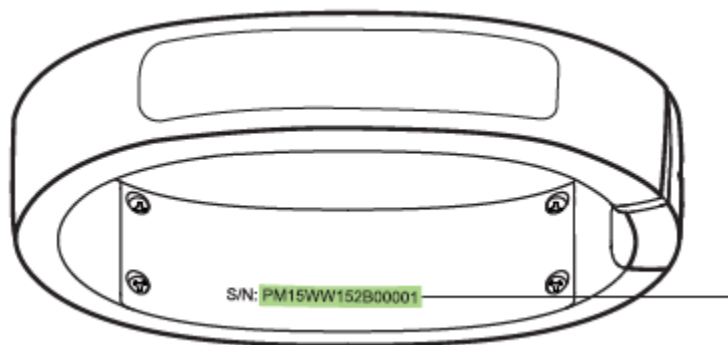

Your product's serial number can be found here

TECHNICAL SUPPORT

What you'll get:

- 1 year limited manufacturer's warranty.
- Free online technical support at www.razersupport.com.

3. USING YOUR RAZER NABU

CHARGING THE NABU

Connect the charging cable from the Razer Nabu to a PC or a USB charger.

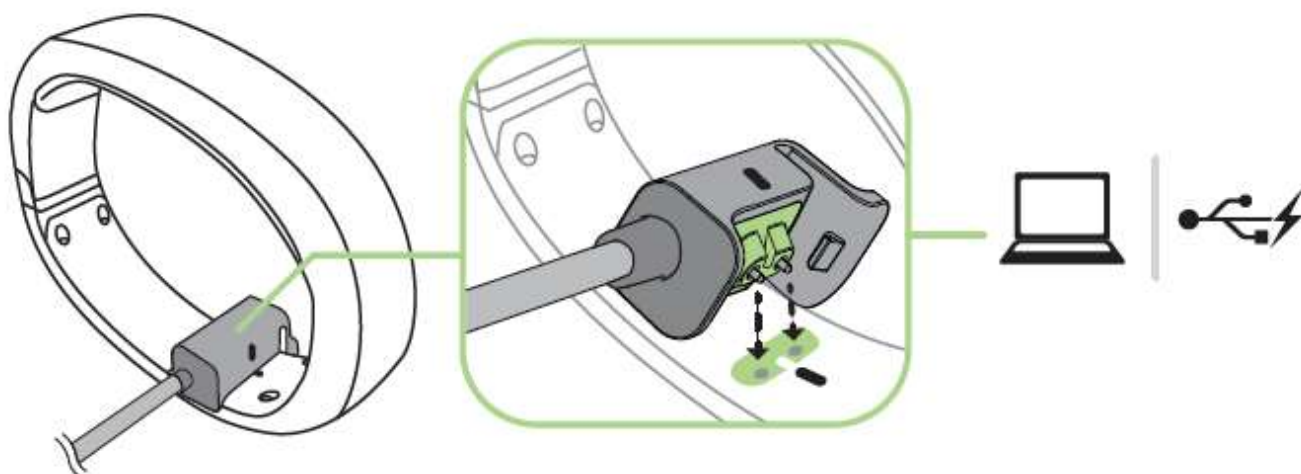

Reminder: Please remove the Razer Nabu from your wrist before charging it. The approximate time to fully charge the Razer Nabu is 90 minutes. Do not leave the Razer Nabu charging overnight.

CHANGING THE CLASP

1. Twist the clasp 90 degrees and then gently pull it away from the wristband.

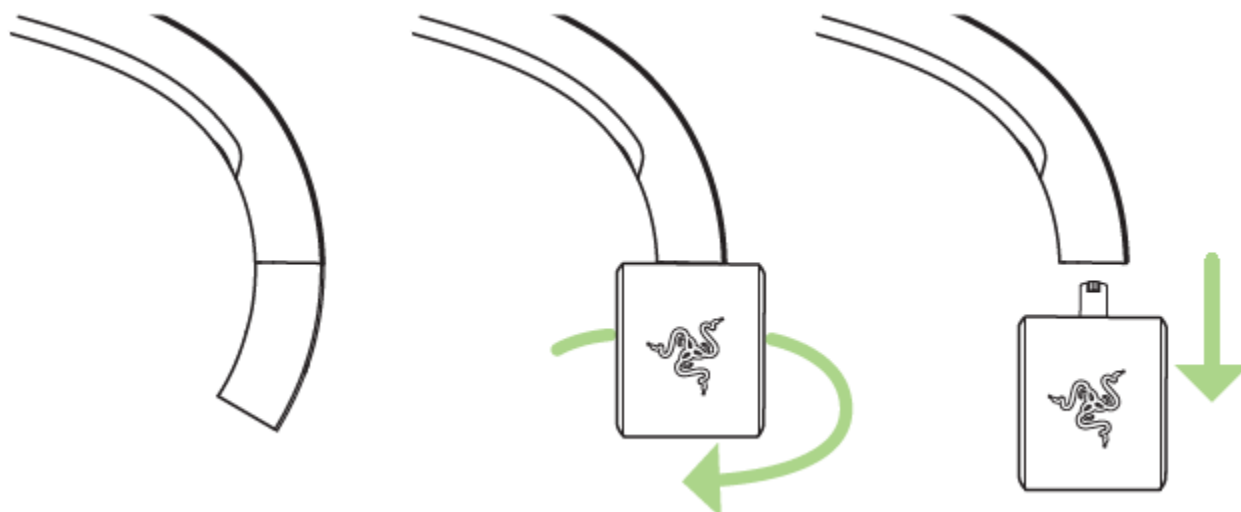

2. Insert the small clasp into the wristband then twist it 90 degrees.

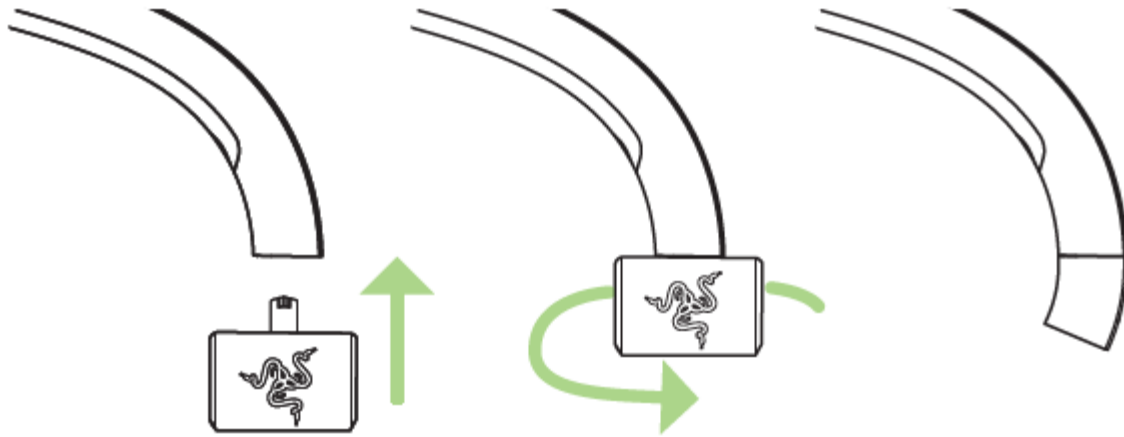

WEARING THE RAZER NABU

1. Hold the band firmly with one hand and use the other hand to unfasten the clasp.



WARNING: Do not overstretch the wristband beyond its physical limits. Doing so may void your warranty.

2. While holding the band with one hand, slide it onto your other wrist.



3. Push the clasp to fasten the band and make sure both ends are aligned.

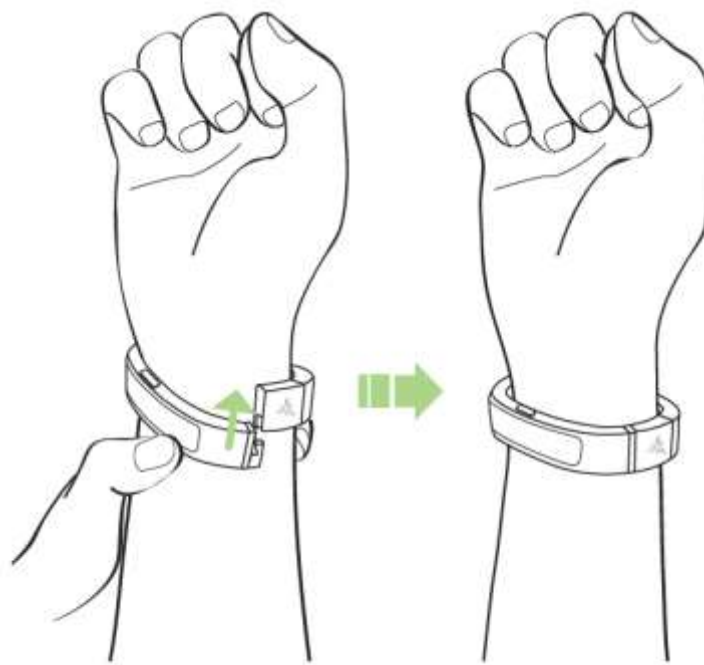

4. Make sure the screen orientation is correct, with the button facing upwards towards your open palm. Press and hold this button for at least 3 seconds to power on the device.

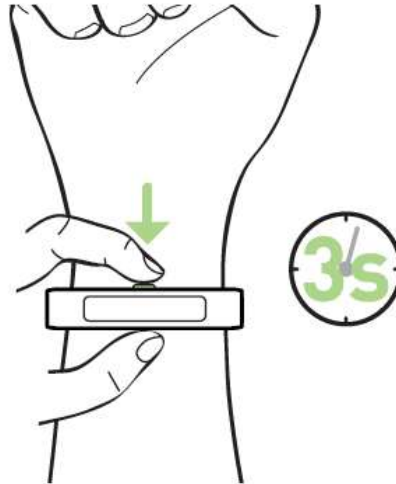

5. Download the Nabu App on your iPhone or Android device, launch it, and follow the onscreen instructions to pair with the band.



Now you're ready to begin!

REMOVING THE RAZER NABU

1. Unfasten the clasp by separating both ends of the band.



2. Hold the band firmly with one hand and gently pull it off your wrist.



4. CONFIGURING YOUR NABU VIA THE UTILITY APP

Disclaimer: The features listed here require you to log in to Razer Synapse 2.0. These features are also subject to change based on the current software version and your Operating System.

WELCOME SCREEN

The welcome screen highlights some of the features you will find on the Razer Nabu app.

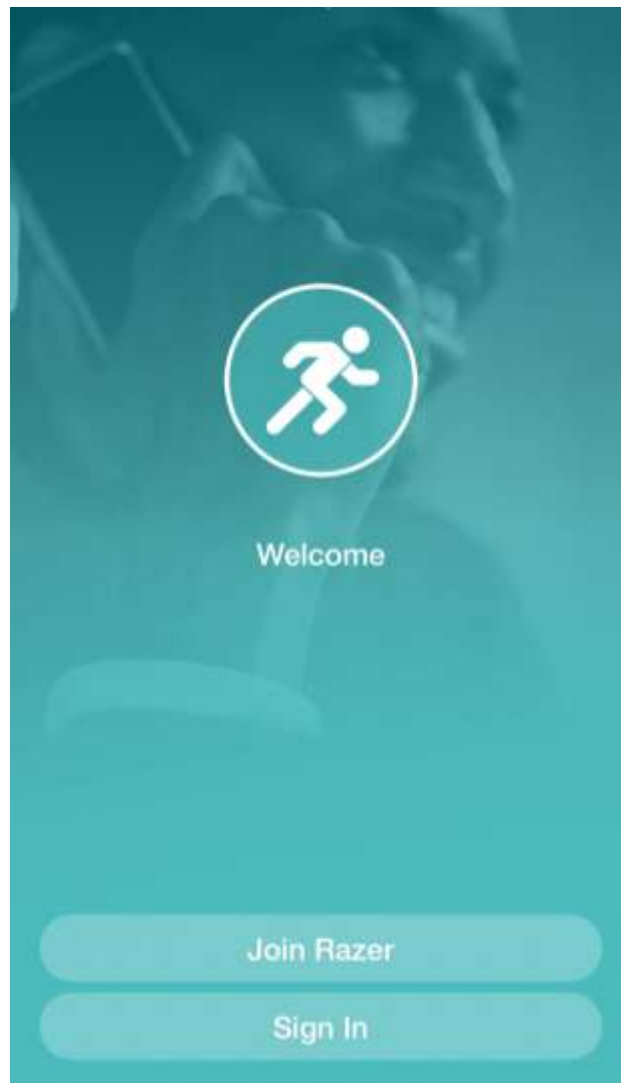

Once you are ready to setup your Razer Nabu, tap “Join Razer” or “Sign In”.

JOIN RAZER SCREEN

To sign up for a Razer ID account, you will need to provide an email, a password, and agree to the Terms of Service and Privacy Policy. Once you have filled out the necessary fields, tap “Next” to continue.

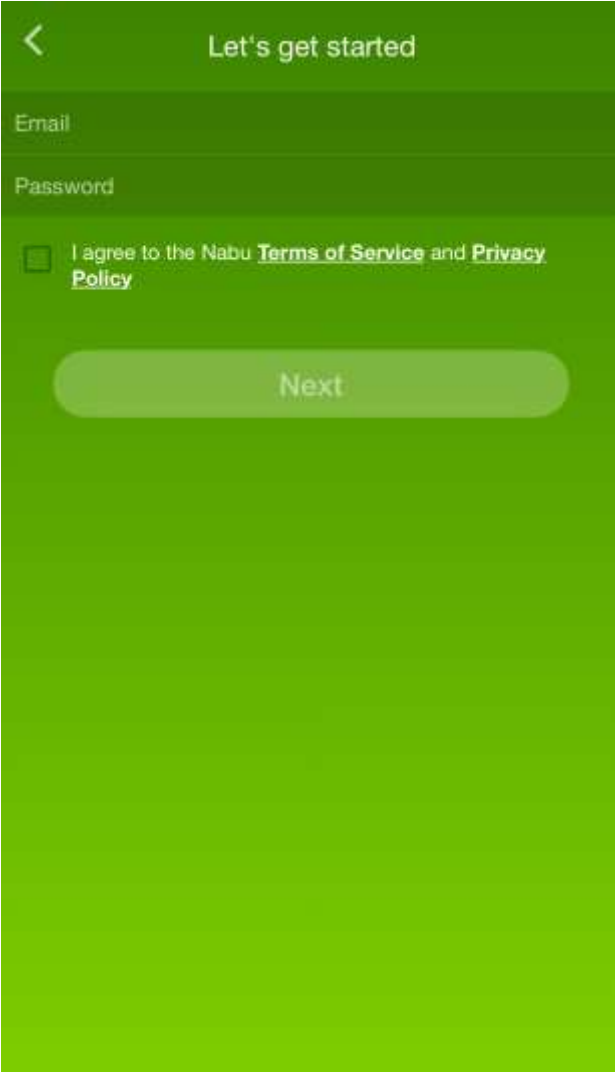
A screenshot of a mobile application's sign-up screen. The background is a solid dark blue. At the top, there is a white back arrow icon on the left and the text "Let's get started" in white. Below this, there are two input fields: "Email" and "Password", both with white text. Under the "Password" field, there is a checkbox with a white border and the text "I agree to the Nabu [Terms of Service](#) and [Privacy Policy](#)" in white. At the bottom of the form, there is a large, rounded rectangular button with a white border and the text "Next" in white.

PERSONALIZE SCREEN

The personalize screen allows you to setup your user profile to be used by fitness apps that support the Razer Nabu.

Name	
First	Last
Birthday	
January 1, 1990	
Height	5'9"
	ft in
Weight	150
	lbs
Gender	
Create Account	

SIGN IN SCREEN

If you already have a Razer ID account, tap “*SIGN IN*” and input your email and password.

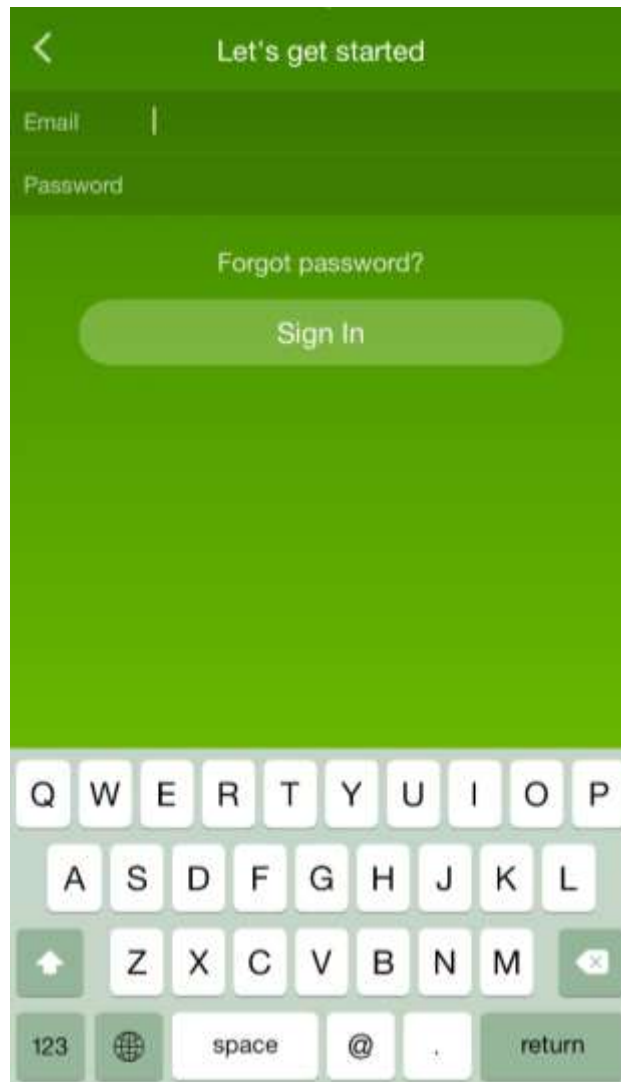

DASHBOARD SCREEN

The Dashboard screen allows you to pair a Razer Nabu to your account as well as configure settings related to your Razer Nabu smartband.

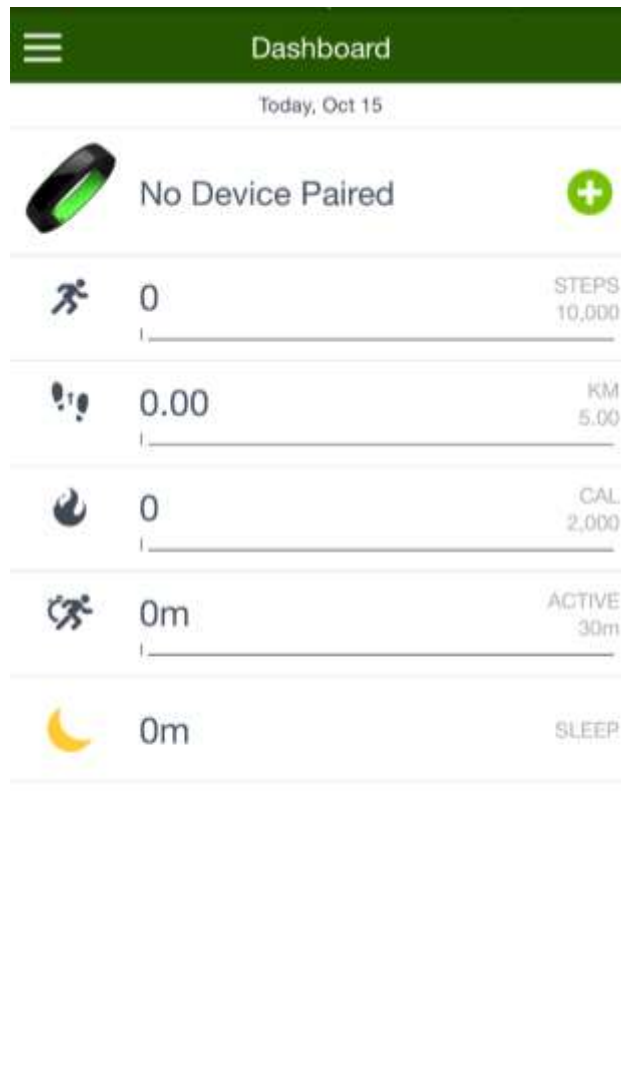

Pairing

To pair a Razer Nabu to your account, tap the  icon on the dashboard screen. The pairing screen will guide you in pairing the Razer Nabu with your smartphone. Simply follow the onscreen instructions until the app successfully finds your Razer Nabu.

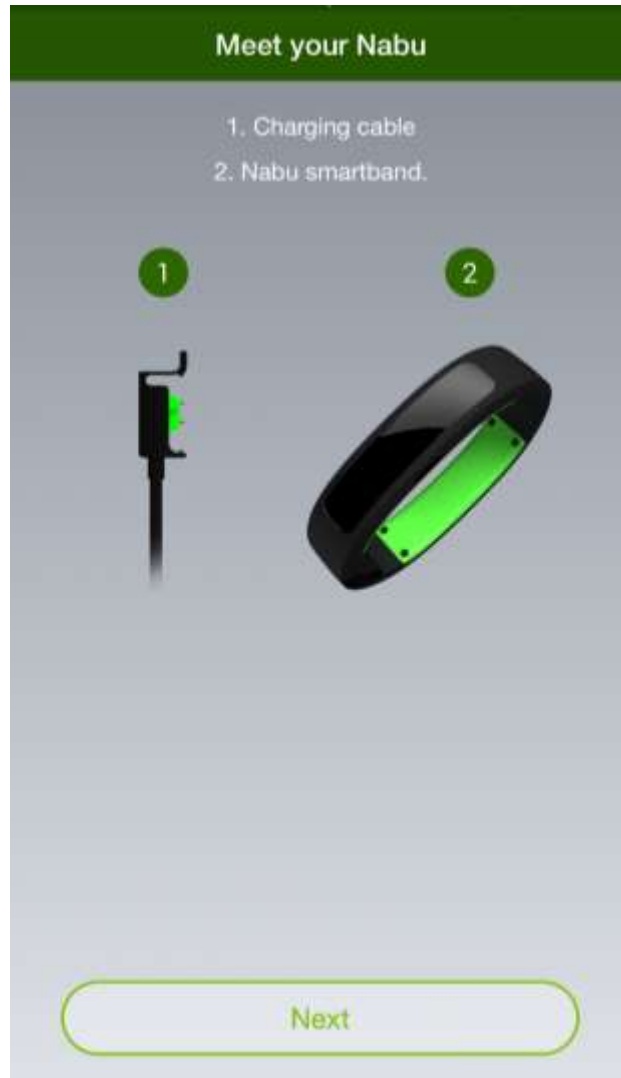

When the app has successfully found your Razer Nabu, a 4-digit code will be shown on the smartband. Type this code on the app to authenticate your Razer Nabu.

Nabu Setup

Enter the number on your Nabu

Not working?

1	2 ABC	3 DEF
4 GHI	5 JKL	6 MNO
7 PQRS	8 TUV	9 WXYZ
	0	

Once you have successfully paired the Razer Nabu to your account, a short tutorial will introduce you to some of the features of your smartband. Once you are finished, tap “Done”.



Settings

On the Dashboard screen, you may tap the image of the Razer Nabu to access numerous settings such as notifications, display, and alarms.



Listed below are the settings and their corresponding functions:

- | | |
|-----------------------|---|
| Details | - View your Razer Nabu's information, update your smartband's firmware, or un-associate your smartband from your phone. |
| Notification Settings | - Choose which instances you would like to be notified. |
| Display Settings | - Customize your Razer Nabu's LED brightness, orientation, style and much more. |
| Alarms | - Create silent alarms for discreet announcements. |
| Social settings | - Enable or disable Handshake and Pulse functionalities |

DRAWER MENU

The drawer menu offers a wide variety of information regarding you, your Razer Nabu, and the App.

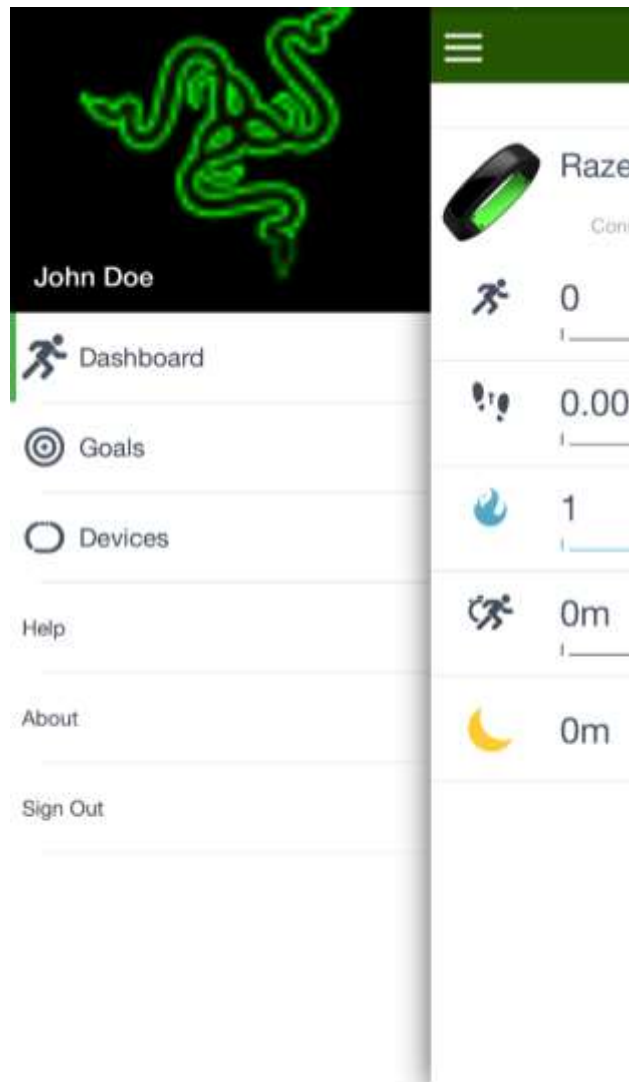

Listed below are the menu options and their corresponding functions:

- Dashboard** - This is your default screen where you can view your progress and access your smartband's settings.
- Goals** - This allows you to customize your fitness goal settings.
- Devices** - View details regarding all Razer devices that are associated to your app.
- Help** - Access the FAQ database to help you troubleshoot your Razer Nabu.
- About** - View the app's version as well as legal documentations.
- Sign Out** - This allows you to log out your account from the app.

5. SAFETY AND MAINTENANCE

SAFETY GUIDELINES

In order to achieve maximum safety while using your Razer Nabu, we suggest that you adopt the following guidelines:

1. Should you have trouble operating the device properly, unplug and/or remove the device and contact the Razer hotline; or go to www.razersupport.com for assistance. Do not attempt to fix the device yourself.
2. Do not take apart the device (doing so will void your warranty) and do not attempt to operate it under abnormal current loads.
3. Charge the Razer Nabu in accordance with the recommended charging time and do not leave the battery charging overnight. Do not wear the Razer Nabu while it is charging.
4. Do not expose the Razer Nabu to liquids while charging. Exposing the Razer Nabu to these conditions may result in an electric shock.
5. The Razer Nabu is splash and dust resistant in compliance with the IP54 standard. Do not submerge the Razer Nabu in liquids and it should not be worn while swimming, bathing, or inside a sauna.
6. Do not tamper or abuse the Razer Nabu; including but not limited to dropping, crushing, excessive bending, puncturing, shredding, microwaving, incinerating, or inserting foreign objects into the Razer Nabu.
7. Do not use abrasive cleaners and/or harsh cleaning agents to clean the Razer Nabu.
8. Do not expose the Razer Nabu to extremely high or low temperatures such as leaving the Razer Nabu in direct sunlight or in snowy weather for extended periods of time.

9. Do not expose the Razer Nabu to open flames such as stoves, candles, or fireplaces.
10. Do not expose the inner band to organic solvents such as alcohol, acetone, and detergent.
11. Dispose the product in accordance with your local environmental laws and guidelines.

BATTERY

The Razer Nabu contains an internal, lithium-ion polymer rechargeable battery. In general, the life expectancy of this battery depends upon use. If the battery does not charge after several attempts, it may be non-operational and you may need to contact customer support. Do not attempt to replace the Razer Nabu's battery yourself.

TRACKING

The accuracy of our sensors and associated calculations (i.e. distance traveled and calories burned) will vary with use.

6. LEGALESE

COPYRIGHT AND INTELLECTUAL PROPERTY INFORMATION

© 2015 Razer Inc. All rights reserved. Razer, For Gamers By Gamers, and the triple-headed snake logo are trademarks or registered trademarks of Razer Inc. and/or affiliated companies in the United States or other countries. All other trademarks are the property of their respective owners. Actual product may differ from pictures. Information is correct at time of printing.

iOS is a trademark or registered trademark of Cisco in the U.S. and other countries and is used under license. Apple, the Apple logo, and iPhone are trademarks of Apple Inc., registered in the U.S. and other countries. App Store is a service mark of Apple Inc.

Android and Google Play are trademarks of Google Inc.

Microsoft, Windows, Windows Phone and Windows logo are trademarks of the Microsoft group of companies.

The Bluetooth® word mark and logos are registered trademarks owned by Bluetooth SIG, Inc. and any use of such marks by Razer is under license.

Razer Inc. ("Razer") may have copyright, trademarks, trade secrets, patents, patent applications, or other intellectual property rights (whether registered or unregistered) concerning the product in this guide. Furnishing of this guide does not give you a license to any such copyright, trademark, patent or other intellectual property right. The Razer Nabu (the "Product") may differ from pictures whether on packaging or otherwise. Razer assumes no responsibility for such differences or for any errors that may appear. Information contained herein is subject to change without notice.

LIMITED PRODUCT WARRANTY

For the latest and current terms of the Limited Product Warranty, please visit www.razerzone.com/warranty.

LIMITATION OF LIABILITY

Razer shall in no event be liable for any lost profits, loss of information or data, special, incidental, indirect, punitive or consequential or incidental damages, arising in any way out of distribution of, sale of, resale of, use of, or inability to use the Product. In no event shall Razer's liability exceed the retail purchase price of the Product.

COSTS OF PROCUREMENT

For the avoidance of doubt, in no event will Razer be liable for any costs of procurement unless it has been advised of the possibility of such damages, and in no case shall Razer be liable for any costs of procurement liability exceeding the retail purchase price of the Product.

GENERAL

These terms shall be governed by and construed under the laws of the jurisdiction in which the Product was purchased. If any term herein is held to be invalid or unenforceable, then such term (in so far as it is invalid or unenforceable) shall be given no effect and deemed to be excluded without invalidating any of the remaining terms. Razer reserves the right to amend any term at any time without notice.