

**ADARO**  
**WIRELESS**  
BLUETOOTH® HEADPHONES



We all require a pair of headphones that can keep up with our work and play, a personal companion that you can take about whether you are chilling on the couch or out on the move. Introducing the Razer Adaro Wireless Bluetooth® headphones – wireless freedom for your music.

The Razer Adaro Wireless is built to follow you wherever you go. Featuring the advanced Bluetooth® 4.0 standard with aptX technology, the Razer Adaro Wireless easily connects to your Bluetooth® audio devices, providing pristine CD-quality audio for up to 20 hours.

Packing high performance, custom-tuned 40mm neodymium magnet drivers, the Razer Adaro Wireless delivers crisp, natural sounding acoustics for an amazing audio experience. These powerful drivers are housed in the Razer Adaro Wireless' custom developed, fully adjustable architecture, allowing for an extremely comfortable and lightweight design.

With its brilliant Razer Adaro sound, wireless portability and comfortable form factor, the Razer Adaro Wireless are the perfect headphones for cord-free music enjoyment on the go.

## TABLE OF CONTENTS

1. PACKAGE CONTENTS / HARDWARE REQUIREMENTS .....	2
2. REGISTRATION / TECHNICAL SUPPORT .....	3
3. TECHNICAL SPECIFICATIONS .....	4
4. DEVICE LAYOUT .....	5
5. USING YOUR RAZER ADARO WIRELESS - BLUETOOTH® HEADPHONES .....	6
6. SAFETY AND MAINTENANCE .....	12
7. LEGALESE .....	13

---

## 1. PACKAGE CONTENTS / HARDWARE REQUIREMENTS

### ***PACKAGE CONTENTS***

- Razer Adaro Wireless - Bluetooth® Headphones
- Micro-USB to USB charging cable
- Quick Start Guide
- Important Product Information Guide

### ***HARDWARE REQUIREMENTS***

Audio Usage

- Devices with Bluetooth® connectivity

For Charging

- Devices with USB ports for charging

---

## 2. REGISTRATION / TECHNICAL SUPPORT

### **REGISTRATION**

Sign up now for a Razer Synapse account to get real-time information on your product's warranty status. To learn more about Razer Synapse and all its features, visit [www.razerzone.com/synapse2](http://www.razerzone.com/synapse2).

If you are already a Razer Synapse user, register your product by clicking on your email address at the Razer Synapse application and select *Warranty Status* from the dropdown list.

To register your product online, visit [www.razerzone.com/registration](http://www.razerzone.com/registration). Please note that you will not be able to view your warranty status if you register via the website.

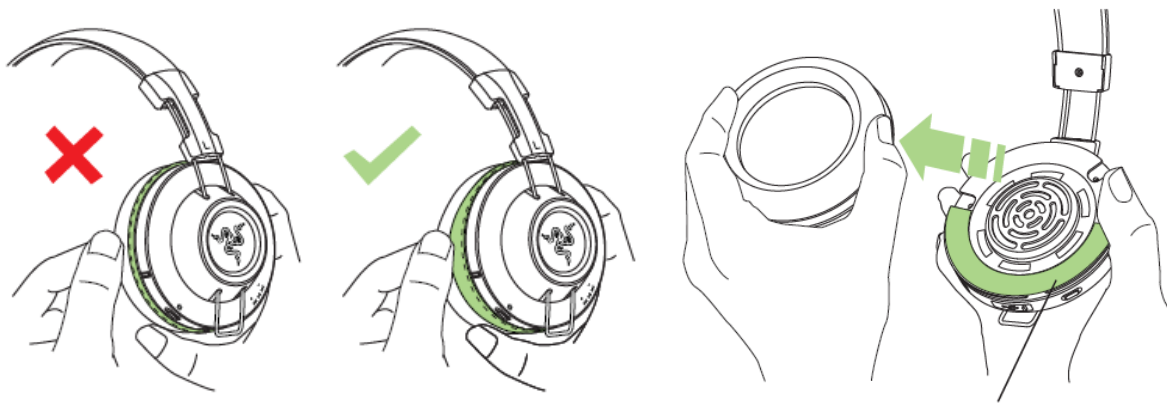

### **TECHNICAL SUPPORT**

What you'll get:

- 1 year limited manufacturer's warranty.
- Free online technical support at [www.razersupport.com](http://www.razersupport.com).

---

### 3. TECHNICAL SPECIFICATIONS

- Bluetooth® v4.0 with aptX Technology
- Drivers: 40 mm Neodymium Magnets
- Frequency Response: 20Hz – 20kHz
- Impedance: 32  $\Omega$
- Sensitivity: 91dB  $\pm$  3dB
- Max Input: 50mW
- Operating Distance: 10m
- Playtime: Up to 20hrs
- Standby Time: Up to 300hrs
- Charging Time: 2.5hrs
- Charging Cable: 0.8m Micro-USB to USB charging cable
- Approximate Weight: 197 g

## 4. DEVICE LAYOUT

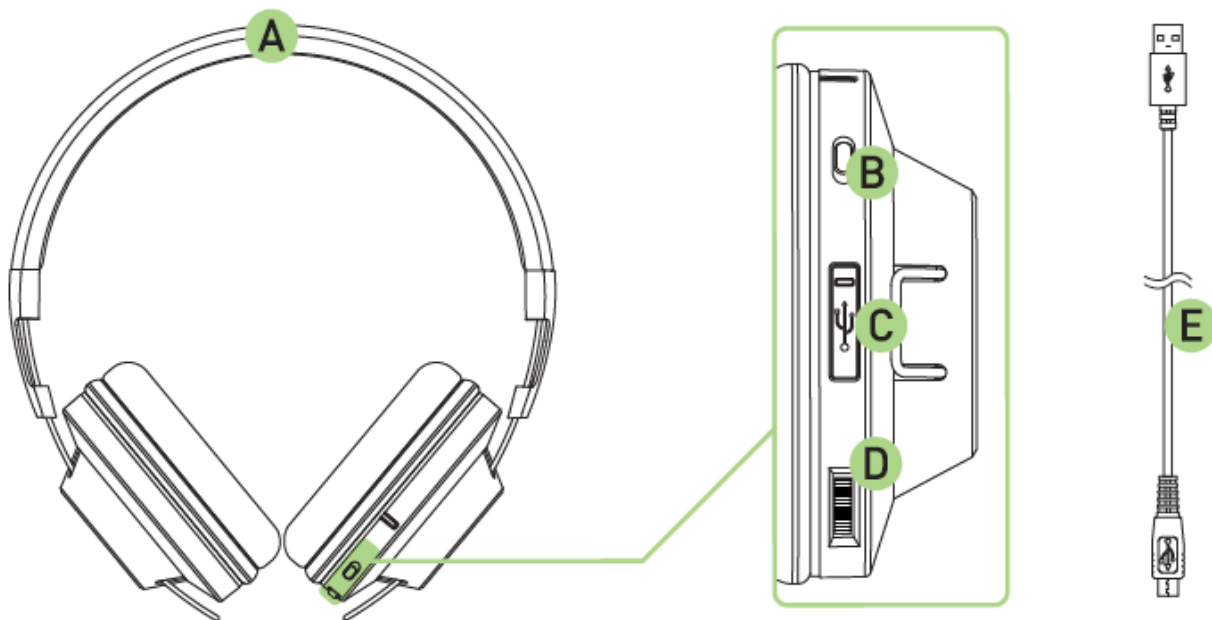

- A. Adjustable Padded Headband
- B. Power / Pairing Button
- C. Micro-USB connector for charging
- D. Playback control button
- E. Micro-USB to USB charging cable

---

## 5. USING YOUR RAZER ADARO WIRELESS - BLUETOOTH® HEADPHONES

### **CHARGING YOUR HEADPHONES**

For best results, please charge the battery fully the first time you use the Razer Adaro Bluetooth® Headphones. A depleted battery will fully charge in about 2.5 hours.

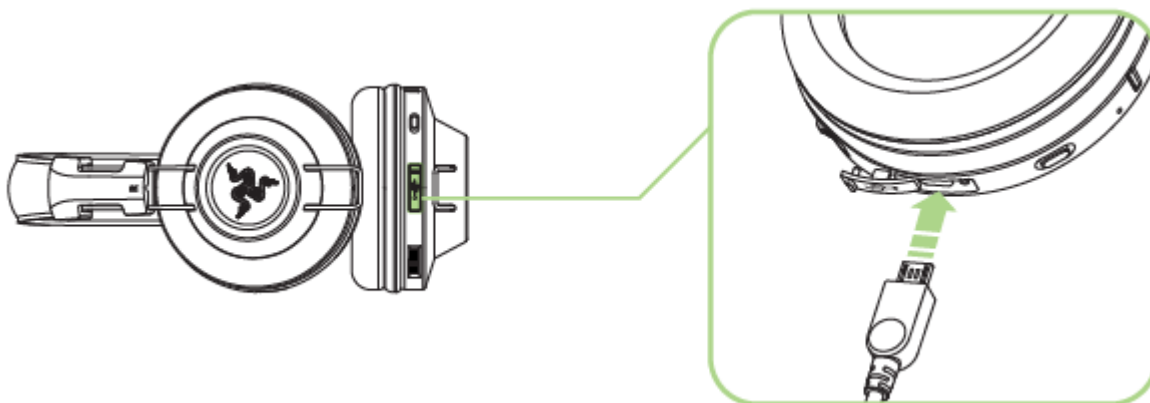

### **POWER ON**

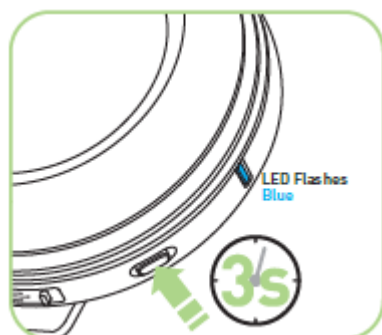

#### **Power On**

Press and hold the power for 3 seconds until the LED flashes blue. You should hear 4 short beeps.

## PAIRING YOUR HEADPHONES TO A BLUETOOTH® DEVICE

1. Upon powering on, the LED should be flashing blue and red alternatively. This indicates that the headphone is now in pairing mode.

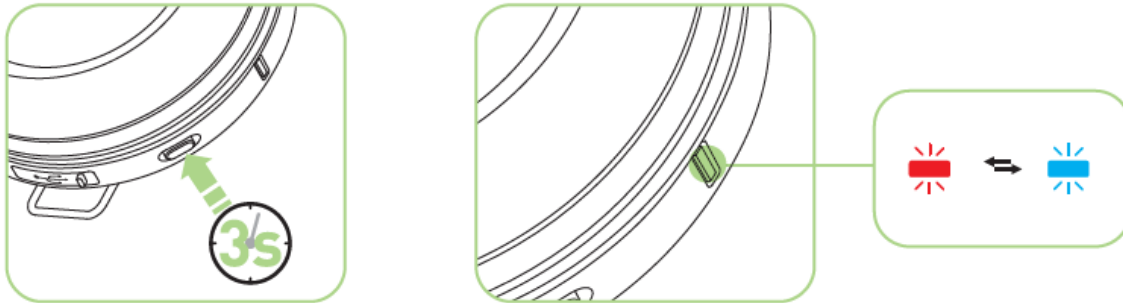

2. Activate Bluetooth® on your device and search for new Bluetooth® devices.



3. Select “Razer Adaro Wireless” from the list of Bluetooth® devices found.
4. Wait for the pairing to complete. Your headphone LED will flash blue 5 times and you should hear 1 short beep.

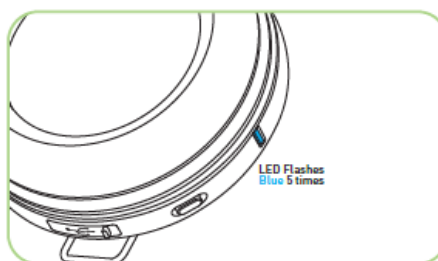

**Note:** The pairing attempt will be stopped if no connection can be established after 2 minutes. 4 short beeps will be played indicating the connection failure.





## PLAYBACK CONTROLS

The following audio playback controls can be accessed directly on the earcups.

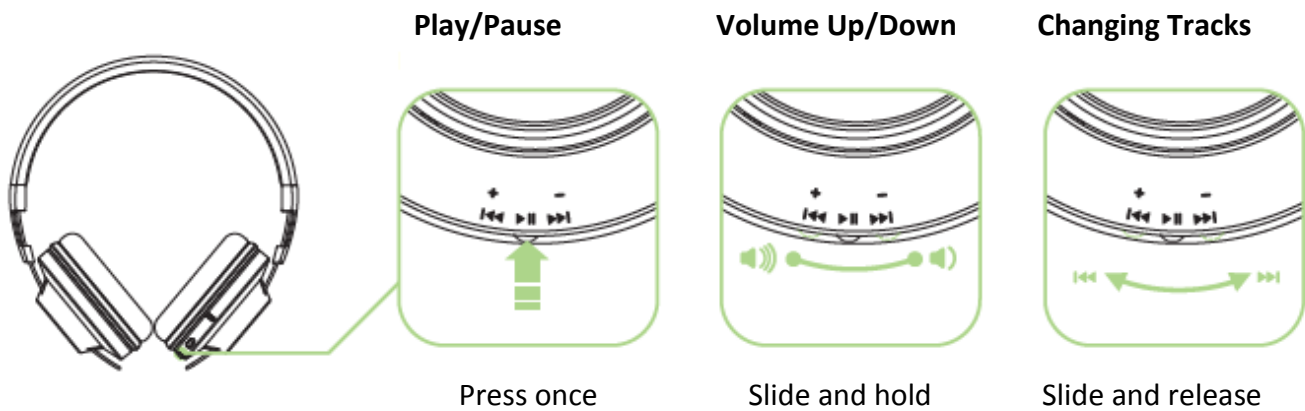

## POWER OFF

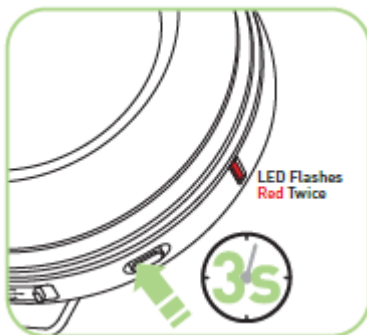



### Power Off



Press and hold the power button for 3 seconds until the LED flashes red twice. You should hear 4 short beeps.

## INDICATORS

### Battery

LED Indication	Sound Indication	Status
 Solid Red	None	Charging
 LED Off	None	Fully charged
 2 red flashes every 3 seconds	5 short beeps	Battery low

## In Use

LED Indication	Sound Indication	Status
 <p>Flashing blue and red alternatively</p>	4 short beeps in increasing tones	Headphones are powered on and in pairing mode
	2 short beeps	Bluetooth® connection disconnected. Headphones return to pairing mode
	2 short beeps followed by 2 low beeps	Connected device is out of range of the headphones. Connection will be reestablished automatically if the device returns within range in 1 minute. Else, the headphones return to pairing mode.
 <p>5 blue flashes</p>	1 short beep	Successful connection
 <p>2 red flashes</p>	4 short beeps in decreasing tones	Power off (by user)
	1 long beep followed by 4 short beeps in decreasing tones	Pairing fails and headphones automatically powers off after 2 minutes.
 <p>2 red/blue flashes every 3 seconds</p>	None	Playing audio
 <p>1 blue flash every 5 seconds</p>	None	Standby

## ***EXTENDING YOUR HEADPHONE'S LIFESPAN***



We recommend stretching the headphones gently apart before placing them over your head to minimize headband stress. However, please avoid overstretching the headphones beyond its technical limits.

---

## 6. SAFETY AND MAINTENANCE

### ***SAFETY GUIDELINES***

In order to achieve maximum safety while using your Razer Adaro Wireless - Bluetooth® Headphones, we suggest that you adopt the following guidelines:

1. Should you have trouble operating the device properly and troubleshooting does not work, unplug the device and contact the Razer hotline or go to [www.razersupport.com](http://www.razersupport.com) for support. Do not attempt to service or fix the device yourself at any time.
2. Do not take apart the device (doing so will void your warranty) and do not attempt to operate it under abnormal current loads.
3. Keep the device away from liquid, humidity or moisture. Operate the device only within the specific temperature range of 0°C (32°F) to 40°C (104°F). Should the temperature exceed this range, unplug and switch off the device in order to let the temperature stabilize within the optimal temperature range.
4. The Razer Adaro Wireless - Bluetooth® Headphones isolates external ambient sounds even at low volumes, resulting in lowered awareness of your external surroundings. Please remove the Razer Adaro Wireless - Bluetooth® Headphones when engaging in any activity that requires active awareness of your surroundings.
5. Listening to excessively loud volumes over extended periods of time can damage your hearing. Furthermore, legislation of certain countries permits a maximum sound level of 86db to affect your hearing for 8 hours a day. We therefore recommend that you reduce the volume to a comfortable level when listening for prolonged periods of time. Please, take good care of your hearing.

### ***MAINTENANCE AND USE***

The Razer Adaro Wireless - Bluetooth® Headphones requires minimum maintenance to keep it in optimum condition. Once a month we recommend you clean the device using a soft cloth or cotton swab with a bit of warm water to prevent dirt buildup. Do not use soap or harsh cleaning agents.

---

## 7. LEGALESE

### ***COPYRIGHT AND INTELLECTUAL PROPERTY INFORMATION***

©2013-2014 Razer Inc. All Rights Reserved. Razer, the Razer Triple-Headed Snake logo, the Razer distressed word logo and other trademarks contained herein are trademarks or registered trademarks of Razer Inc. and/or its affiliated or associated companies, registered in the United States and/or other countries.

Razer Inc. (“Razer”) may have copyright, trademarks, trade secrets, patents, patent applications, or other intellectual property rights (whether registered or unregistered) concerning the product in this Quick Start Guide. Furnishing of this Quick Start Guide does not give you a license to any such copyright, trademark, patent or other intellectual property right. The Razer Adaro Wireless - Bluetooth® Headphones (the “Product”) may differ from pictures whether on packaging or otherwise. Razer assumes no responsibility for such differences or for any errors that may appear. Information contained herein is subject to change without notice.

### ***LIMITED PRODUCT WARRANTY***

For the latest and current terms of the Limited Product Warranty, please visit [www.razerzone.com/warranty](http://www.razerzone.com/warranty).

### ***LIMITATION OF LIABILITY***

Razer shall in no event be liable for any lost profits, loss of information or data, special, incidental, indirect, punitive or consequential or incidental damages, arising in any way out of distribution of, sale of, resale of, use of, or inability to use the Product. In no event shall Razer’s liability exceed the retail purchase price of the Product.

### ***COSTS OF PROCUREMENT***

For the avoidance of doubt, in no event will Razer be liable for any costs of procurement unless it has been advised of the possibility of such damages, and in no case shall Razer be liable for any costs of procurement liability exceeding the retail purchase price of the Product.

### ***GENERAL***

These terms shall be governed by and construed under the laws of the jurisdiction in which the Product was purchased. If any term herein is held to be invalid or unenforceable, then such term (in so far as it is invalid or unenforceable) shall be given no effect and deemed to be excluded without invalidating any of the remaining terms. Razer reserves the right to amend any term at any time without notice.

The aptX® mark and the aptX logo are trade marks of CSR plc or one of its group companies and may be registered in one or more jurisdictions.

