DRIVER INSTALLATION INSTRUCTIONS

APPLICABLE MODEL NUMBERS

- RZ09-03101

DRIVER NAME AND VERSION

Intel Chipset Driver Version 10.1.12.2

INSTRUCTIONS

Note: This download is for the original driver that was installed on your Razer Laptop. Updates for this driver are available via standard Windows Updates. To ensure you have the latest driver installed on your Blade please make sure to apply all available updates from Windows.

Please follow the instructions below to download and install the original driver for your Blade. Following the installation, it is recommended to search for any available Windows Updates.

1. Ensure that your Blade is plugged into a wall outlet and not running on battery alone before proceeding.
2. Save any open documents on your computer and close all other programs before attempting this update.
3. Download the driver from the link below. You will need to right click the .zip folder and choose to extract the files to location of your choosing (such as your desktop) to locate the files for the installation process.

<http://rZR.to/TvdKN>

4. Once you have extracted the file proceed to the installation steps below.

INSTALLATION PROCESS

1. To initiate the initial process, Double-click on the SetupChipset.exe (Application) as shown in the image below:

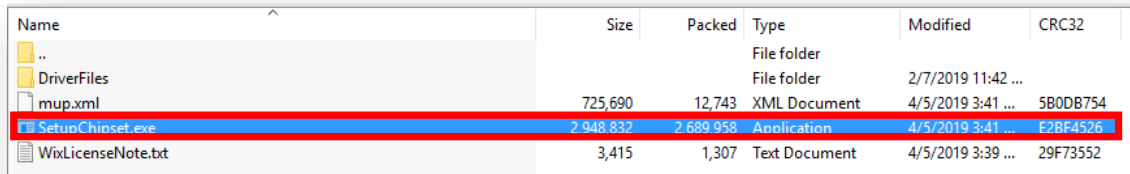

Name	Size	Packed	Type	Modified	CRC32
..			File folder		
DriverFiles			File folder	2/7/2019 11:42 ...	
mup.xml	725,690	12,743	XML Document	4/5/2019 3:41 ...	5B0DB754
SetupChipset.exe	2,948,832	2,689,958	Application	4/5/2019 3:41 ...	F28F4526
WixLicenseNote.txt	3,415	1,307	Text Document	4/5/2019 3:39 ...	29F73552

2. The Intel® Chipset Device Software will prompt you to exit all other programs. Once done with the message, click "Next".

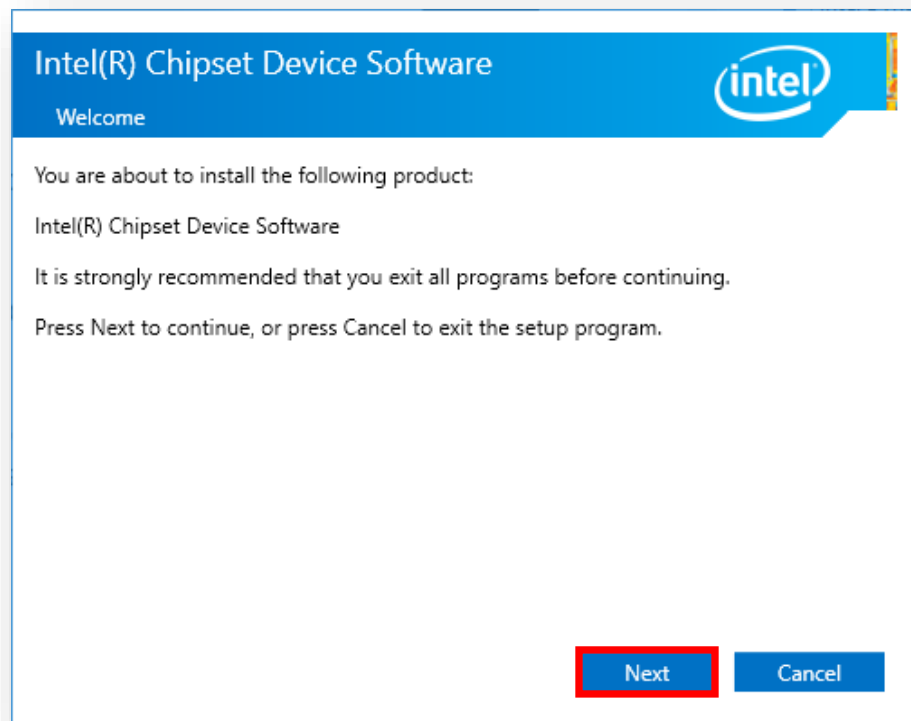

3. A license agreement will appear on the screen. Read the terms of the agreement and once done, click "Accept".

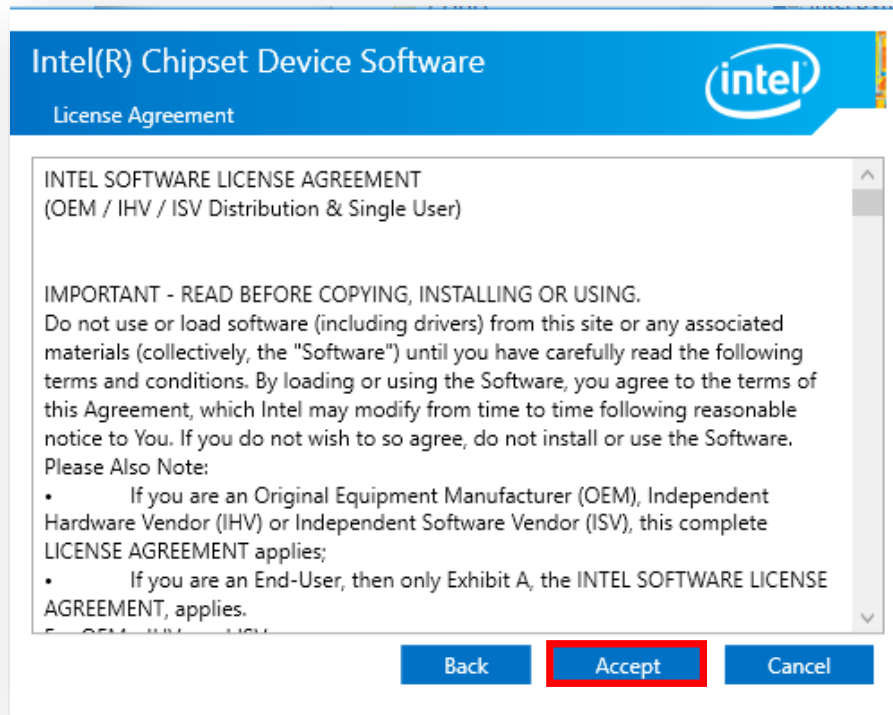

4. A confirmation of the Installation will appear, click "Install".

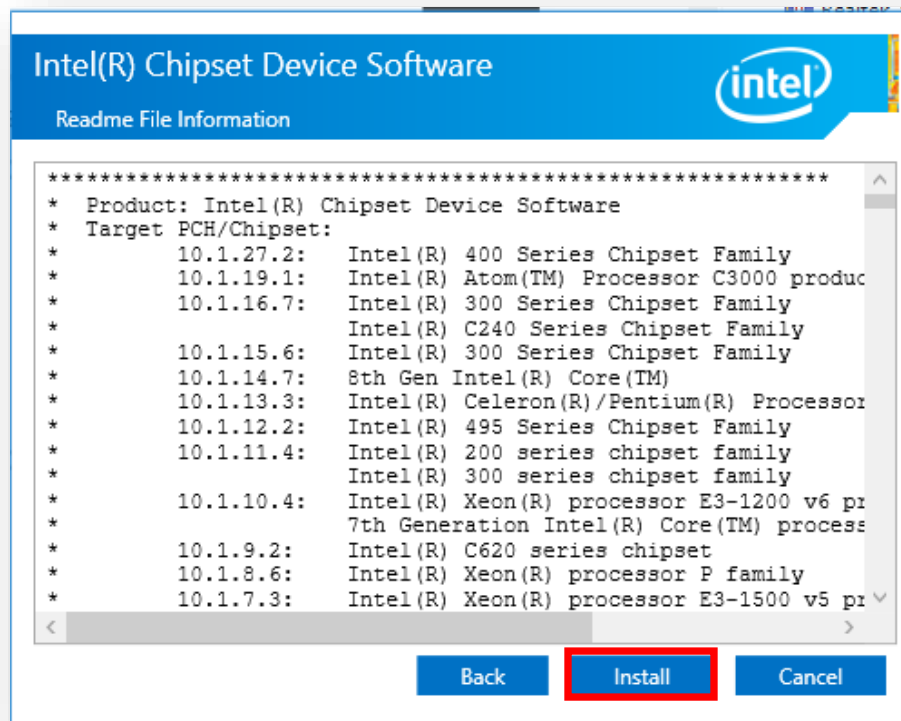

5. Click "UPDATE" to initiate the update process of your Razer Blade laptop. You may lose control of your mouse and keyboard during the updating process. You will also not be able to proceed if you already have the latest software installed.

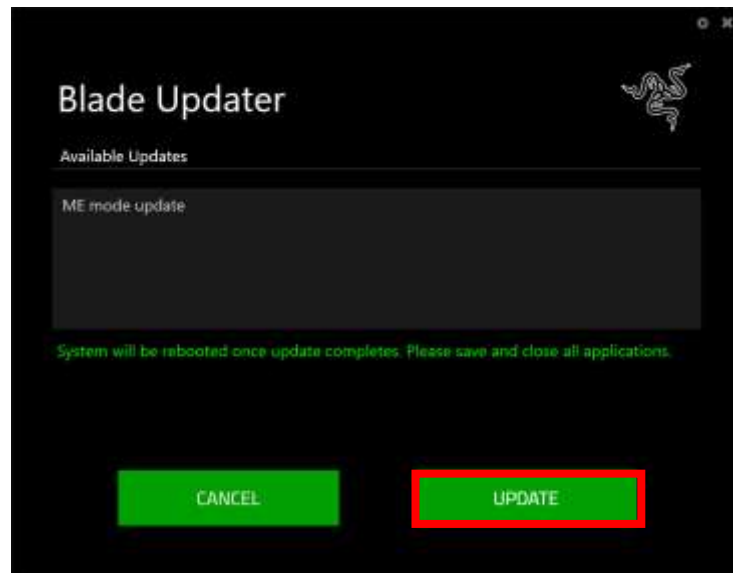

6. A progress bar will appear indicating the status and progression of the installation process. During the install process, you will not have access to other applications. This update may take 15 minutes or longer to complete. Do not interrupt the installation process.
7. Once the progress bar reaches 100% completion, your Razer Blade will restart automatically. No further action or steps are required after the progress bar reaches 100%. Once your Blade has restarted your system will be updated.