DRIVER INSTALLATION INSTRUCTIONS

APPLICABLE MODEL NUMBERS

- RZ09-03100

DRIVER NAME AND VERSION

Dolby Atmos APP Version 3.20402.409.0 x64

INSTRUCTIONS

Note: This download is for the original driver that was installed on your Razer Laptop. Updates for this driver are available via standard Windows Updates. To ensure you have the latest driver installed on your Blade please make sure to apply all available updates from Windows.

Please follow the instructions below to download and install the original driver for your Blade. Following the installation, it is recommended to search for any available Windows Updates.

1. Ensure that your Blade is plugged into a wall outlet and not running on battery alone before proceeding.
2. Save any open documents on your computer and close all other programs before attempting this update.
3. Ensure that you have downloaded and installed the Dolby driver first before proceeding to the installation of the Dolby Atmos APP. You can download the driver and the app through the links below:

Dolby Driver: <http://rZR.to/oUIDA>

Dolby Atmos App: <http://rZR.to/vhsZB>

4. Once you have extracted the file, proceed to the installation steps below.

INSTALLATION PROCESS

1. Double click on 2a409f4c40c3462fa2e331a2852066d4.appx to launch the installer.

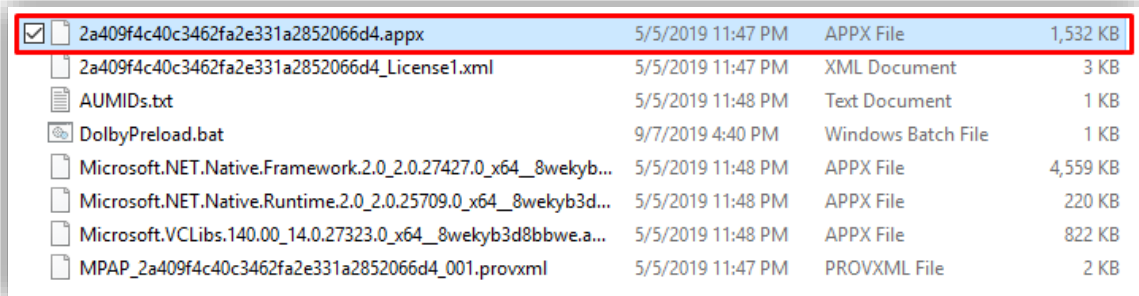

2. The User Account Control will appear on the screen. Select "Yes" to continue.

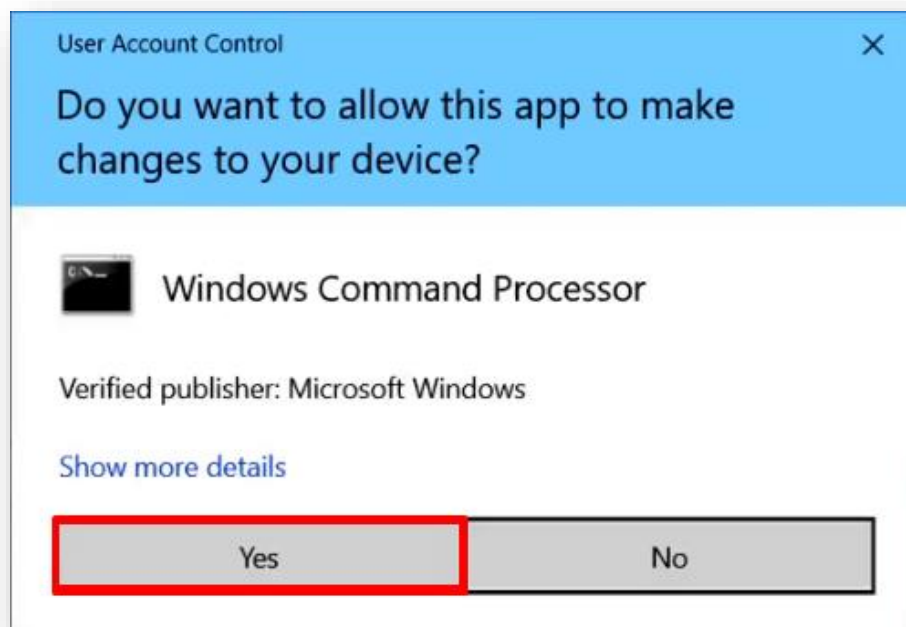

3. A command prompt will pop up on the screen. Wait for "Press any key to continue...", then press any key to complete the process.

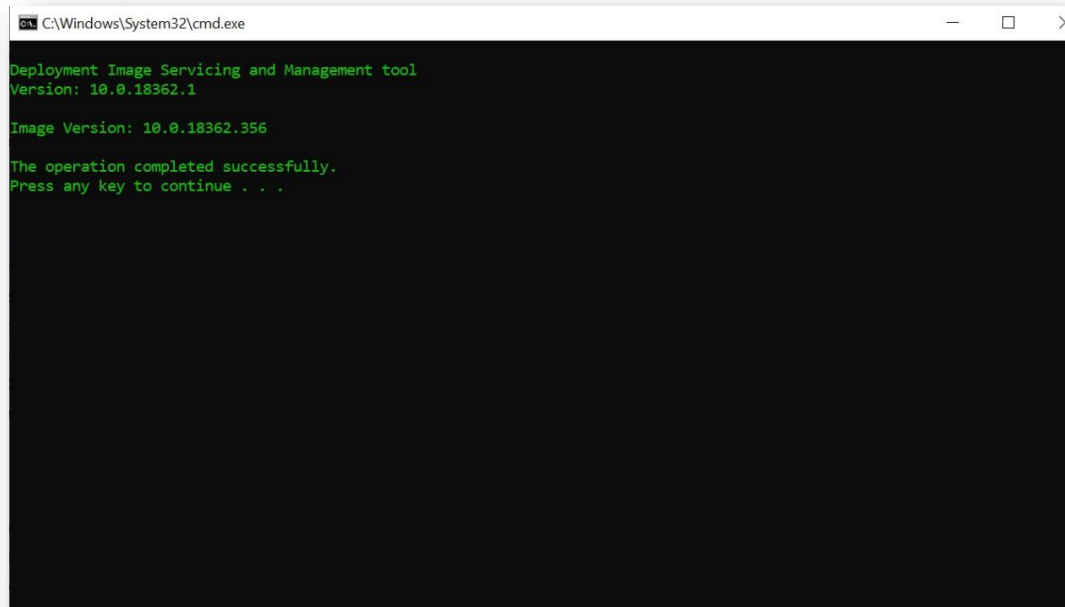

```
C:\Windows\System32\cmd.exe

Deployment Image Servicing and Management tool
Version: 10.0.18362.1

Image Version: 10.0.18362.356

The operation completed successfully.
Press any key to continue . . .
```